

angles from Mt Coppola

Gell 10

- 74 40 Angri to Rocigliano S. Arzano & T. della Cumvriata West end  
63 30 Angri to Somma top  
68 16 Vesuvius & Sarno north left of it & sandy coast  
88 45 Villa Hamilton & point  
92 points or capes by T. del Greco & the great Asylum of Naples  
55 30 Angri to Vitiello & R. end of Bosco reale  
26 30 Angri to Scafati  
13 Mt of Sarno & left end of town  
9.30 Castello of L. above to Angri  
16 30 Angri to Sarno Seminary  
41 45 Angri to Nola  
31 Angri to Palmis  
50 30 Angri to Giacalillo  
9 Angri to L. projecting end of Sarno Mt. & Right end of town & peak R.  
R of Angri is Mt detached near Nocera  
101 30 Vesuvius to Mt Belvidere a Piedole  
47 Rocigliano to Quisiana Castle of Ca mare & Misenum, behind  
in this line is Piedimonte where the road to Belvidere  
end September 1826.



House of Ceres

Thyrsus in new excavation opposite T. of Fortune

in S<sup>t</sup> near Pantheon  
called del Naviglio Ceres & Bacchus



Arch painted in Pantheon

wall of Dioscuri  
CAM PANI VICTORIA  
CVM NV CERINIS

A V E T T I V M · F I R M U M

N V M I S I V S · I N C V N D V S · C V M · S E C V N D O

E T · V I C T O R E · R O Q

Plates  
 1 Frontispiece  
 2 General plan  
 3 wall of boudoir  
 4 do do  
 5 Red wall & window  
 6 Door of a house  
 7 Picture behind Chalcedon  
 8 Stairs of Rumachia  
 9 Statue of do  
 10 Forum pedestals  
 11 altar of jove  
 12 Pic. in house of Bacchus  
 13 Pantheon gen view  
 14 wall of do red black  
 15 upper Fenelope  
 16 Rect. of Pantheon  
 17 the Muse  
 18 Cell of Pantheon  
 19 Plan of Top of Fortuna  
 20 View of do  
 21 Restoration of do  
 22 do view from top of Baths  
 23 Plan of Baths  
 24 Gen view of do  
 25 Section  
 26 Court of thornae  
 27 Frigidarium  
 28 Natatio  
 29 Tepidarium  
 30 Roof of Tepidarium  
 31 Calidarium  
 32 Section of  
 33 Womens Baths  
 34 outer view of do  
 35 Plan of Trajic Post house  
 36 View of court  
 37 Restoration  
 38 Windows to Vicus

Vignettes  
 1 Cupid & nudes

Plates  
 39 Pic. Achilles & Briseis  
 40 Fac simile of achilles  
 41 Pelas & Treis  
 42 Venus fishing  
 43 Ariadne & Inphurium  
 44 Post reading  
 45 Mosaic  
 46 Inphuricia  
 47 Wall of pheda  
 48 Leda picture  
 49 Ariadne  
 50  
 51  
 52  
 53  
 54  
 55  
 56  
 57  
 58  
 59  
 60 Plan of this part  
 61 View of Street of Maxing  
 62 House of Lanes view  
 63 House of Dioscuri Plan  
 64 View of great court  
 65 View of Piston court  
 66 Jupiter  
 67 Andromeda  
 68 Hygeia  
 69 Achilles in Scyros  
 70 Drinking scene  
 71 Love scene  
 72 Dream of Rhea  
 73 Inside of walls  
 74 gate of do  
 75  
 76 Gen view from Court of a maie  
 77  
 78  
 79  
 80  
 81

VIII  
 continued  
 Chap I  
 Chap II  
 VIII  
 Vis Phryxus  
 Chap 8  
 Chap 9  
 Chap 10  
 Chap 11  
 Chap 12  
 Chap 13  
 Chap 14  
 Chap 15  
 Chap 16  
 Chap 17  
 Chap 18  
 Chap 19  
 Chap 20  
 Chap 21  
 Chap 22  
 Chap 23  
 Chap 24  
 Chap 25  
 Chap 26  
 Chap 27  
 Chap 28  
 Chap 29  
 Chap 30  
 Chap 31  
 Chap 32  
 Chap 33  
 Chap 34  
 Chap 35  
 Chap 36  
 Chap 37  
 Chap 38  
 Chap 39  
 Chap 40  
 Chap 41  
 Chap 42  
 Chap 43  
 Chap 44  
 Chap 45  
 Chap 46  
 Chap 47  
 Chap 48  
 Chap 49  
 Chap 50  
 Chap 51  
 Chap 52  
 Chap 53  
 Chap 54  
 Chap 55  
 Chap 56  
 Chap 57  
 Chap 58  
 Chap 59  
 Chap 60  
 Chap 61  
 Chap 62  
 Chap 63  
 Chap 64  
 Chap 65  
 Chap 66  
 Chap 67  
 Chap 68  
 Chap 69  
 Chap 70  
 Chap 71  
 Chap 72  
 Chap 73  
 Chap 74  
 Chap 75  
 Chap 76  
 Chap 77  
 Chap 78  
 Chap 79  
 Chap 80  
 Chap 81

Thornae  
 6  
 7  
 8  
 9  
 10  
 11  
 12  
 13  
 14  
 15  
 16  
 17  
 18  
 19  
 20  
 21  
 22  
 23  
 24  
 25  
 26  
 27  
 28  
 29  
 30  
 31  
 32  
 33  
 34  
 35  
 36  
 37  
 38  
 39  
 40  
 41  
 42  
 43  
 44  
 45  
 46  
 47  
 48  
 49  
 50  
 51  
 52  
 53  
 54  
 55  
 56  
 57  
 58  
 59  
 60  
 61  
 62  
 63  
 64  
 65  
 66  
 67  
 68  
 69  
 70  
 71  
 72  
 73  
 74  
 75  
 76  
 77  
 78  
 79  
 80  
 81

Womens baths  
 33  
 34  
 35  
 36  
 37  
 38  
 39  
 40  
 41  
 42  
 43  
 44  
 45  
 46  
 47  
 48  
 49  
 50  
 51  
 52  
 53  
 54  
 55  
 56  
 57  
 58  
 59  
 60  
 61  
 62  
 63  
 64  
 65  
 66  
 67  
 68  
 69  
 70  
 71  
 72  
 73  
 74  
 75  
 76  
 77  
 78  
 79  
 80  
 81

VIII  
 72 Pavement  
 73 marble

Vignettes  
 1 flying figure of Pantheon  
 2 TO of Trajic Post  
 3 Cupid & nudes  
 4 view & borders

Chap II  
 5 architect group Chalcedon  
 6 + Pantheon  
 7 Cincelon vignette  
 8 do do

Chap III  
 9 of Pantheon  
 10 of Pantheon

Chap V  
 11 + do  
 12 + Cornucopia

Chap VI  
 13 + Vignette non-Tom of  
 14 + Sudent Apollo

Chap VII  
 15 + do  
 16 + do  
 17 Phryxus  
 18 Bacchus  
 19 female Bacchant  
 20 Bacchus

Chap VIII  
 21  
 22

Chap IX  
 23 group of Trajic  
 24 Mercury fountain  
 25  
 26  
 27  
 28  
 29  
 30  
 31  
 32  
 33  
 34  
 35  
 36  
 37  
 38  
 39  
 40  
 41  
 42  
 43  
 44  
 45  
 46  
 47  
 48  
 49  
 50  
 51  
 52  
 53  
 54  
 55  
 56  
 57  
 58  
 59  
 60  
 61  
 62  
 63  
 64  
 65  
 66  
 67  
 68  
 69  
 70  
 71  
 72  
 73  
 74  
 75  
 76  
 77  
 78  
 79  
 80  
 81

Want 2. 6. 11. 12. 13. 14

70 drinking scene  
 71 Wagon  
 72 Love scene  
 73 Dream of Rhea  
 74 Inside of walls  
 75 gate of do  
 76 View from Castellamare  
 77 Pavements  
 78 marble  
 79 Achilles in Scyros  
 80 Victory  
 81

on Capital

marble capital 1 foot 7 in x 1/2 high  
 horns 7 1/2 in x 1/2  
 Capitals of Pantheon  
 entry of it from Forum

Chap VIII  
 Trajic Post

Chap IX  
 Fullonica

Chap X  
 House of Forum

9 in 2/3 diam these  
 columns of forum entrance  
 yellow blue red yellow

in Pantheon

Chap XI  
 21  
 22  
 23  
 24  
 25  
 26  
 27  
 28  
 29  
 30  
 31  
 32  
 33  
 34  
 35  
 36  
 37  
 38  
 39  
 40  
 41  
 42  
 43  
 44  
 45  
 46  
 47  
 48  
 49  
 50  
 51  
 52  
 53  
 54  
 55  
 56  
 57  
 58  
 59  
 60  
 61  
 62  
 63  
 64  
 65  
 66  
 67  
 68  
 69  
 70  
 71  
 72  
 73  
 74  
 75  
 76  
 77  
 78  
 79  
 80  
 81

Chap XI  
 21  
 22  
 23  
 24  
 25  
 26  
 27  
 28  
 29  
 30  
 31  
 32  
 33  
 34  
 35  
 36  
 37  
 38  
 39  
 40  
 41  
 42  
 43  
 44  
 45  
 46  
 47  
 48  
 49  
 50  
 51  
 52  
 53  
 54  
 55  
 56  
 57  
 58  
 59  
 60  
 61  
 62  
 63  
 64  
 65  
 66  
 67  
 68  
 69  
 70  
 71  
 72  
 73  
 74  
 75  
 76  
 77  
 78  
 79  
 80  
 81

Chap XII  
 25  
 26  
 27  
 28  
 29  
 30  
 31  
 32  
 33  
 34  
 35  
 36  
 37  
 38  
 39  
 40  
 41  
 42  
 43  
 44  
 45  
 46  
 47  
 48  
 49  
 50  
 51  
 52  
 53  
 54  
 55  
 56  
 57  
 58  
 59  
 60  
 61  
 62  
 63  
 64  
 65  
 66  
 67  
 68  
 69  
 70  
 71  
 72  
 73  
 74  
 75  
 76  
 77  
 78  
 79  
 80  
 81

Chap XIII  
 27  
 28  
 29  
 30  
 31  
 32  
 33  
 34  
 35  
 36  
 37  
 38  
 39  
 40  
 41  
 42  
 43  
 44  
 45  
 46  
 47  
 48  
 49  
 50  
 51  
 52  
 53  
 54  
 55  
 56  
 57  
 58  
 59  
 60  
 61  
 62  
 63  
 64  
 65  
 66  
 67  
 68  
 69  
 70  
 71  
 72  
 73  
 74  
 75  
 76  
 77  
 78  
 79  
 80  
 81

Chap XIV  
 27  
 28  
 29  
 30  
 31  
 32  
 33  
 34  
 35  
 36  
 37  
 38  
 39  
 40  
 41  
 42  
 43  
 44  
 45  
 46  
 47  
 48  
 49  
 50  
 51  
 52  
 53  
 54  
 55  
 56  
 57  
 58  
 59  
 60  
 61  
 62  
 63  
 64  
 65  
 66  
 67  
 68  
 69  
 70  
 71  
 72  
 73  
 74  
 75  
 76  
 77  
 78  
 79  
 80  
 81

From Sarno

- 5<sup>th</sup> aqueduct to m<sup>ts</sup> with zigzag road 30 200  
 41 40 Nocera Pagani Mt begins  
 58 20 Dip & road to Nocera  
 71 Range begins of Mt behind Sarno  
 Vesuvius to Capri <sup>mid Archangel</sup> 45. 20 a point of S Angelo Mt.  
 Vesuvius to Quisisana sans 58. 30  
 Sarno to S Angelo 66. 30

From Bosco Reale, Vajano's house

- 123 30 Vesuvius top to about Vico & gap beyond  
 27 30 1<sup>o</sup> gap to S Angelo near Quisisana  
 21 30 S Angelo to table hill  
 37 S an to Nocera m<sup>t</sup>  
 80 abt gap to Salerno  
 62 Vesuvius to Somma top  
 41 30 Somma to Pacapago top  
 53 15 whole breadth of Mt Vesuvius

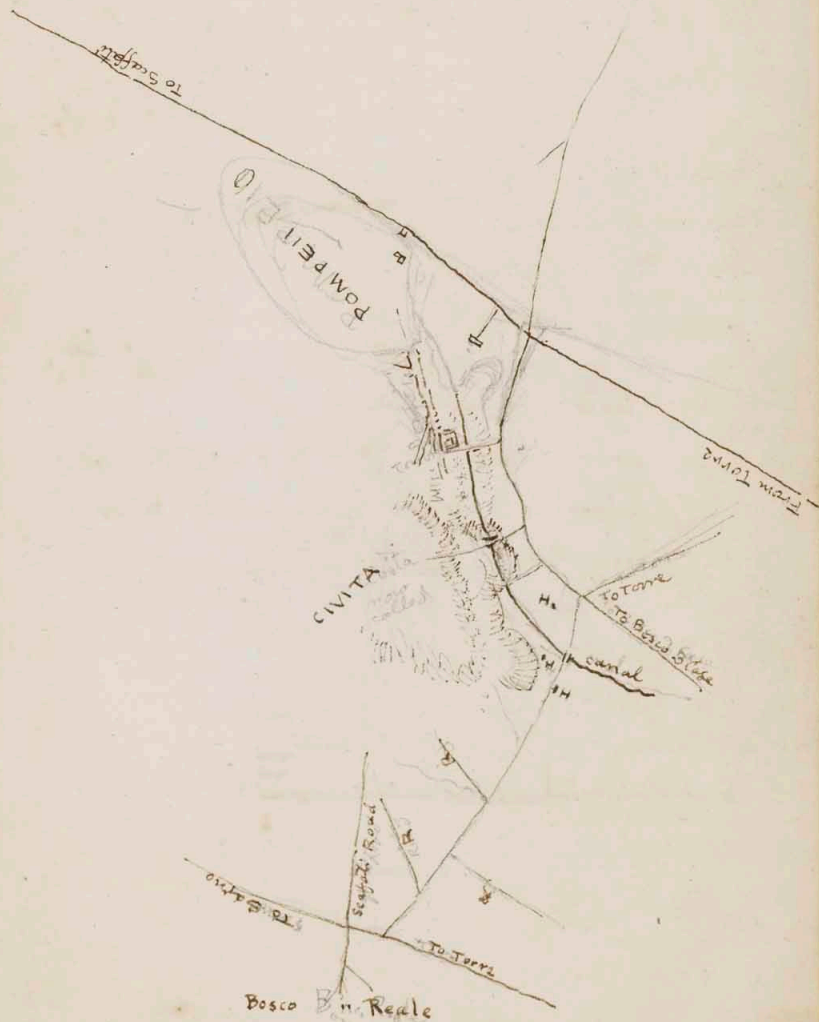



continued to R  
red below

Fullonica



Fullonica



Fountain behind the house of  
The Tragic Poet.  
The Dyer's House

II 20EHTI R7C7

scratched on wall  
of Tragic Poet's house

IVSTVS

Cold cistern

Bath 2 ft 4 in

PISCINA

12.10 wide

12	10
2	1/4 1/2
10	1 1/2
16	2 1/2

18.6

7 ft 10 high to frieze

arches spring 5-6 from floor

2 ft 5 above begins cornice frieze  
arch abt. 7.8 high

Frieze 10 inches wide

ft. 2 below frieze  
arch 9 inches  
spring 5

Baths. Court of Col<sup>3</sup> above 1 foot 6 in diameter Tall Doric  
1 capital on ground, 2 perricos & 2 closed arches on side  
next the street of T. Fortune. On opposite side  
60 feet  
on West? 3 intercolumniations open & 2 shut with  
a dwarf wall. !  
From Wall of Calidarium to the opposite  
wall of court which is nearest Forum 60 feet.

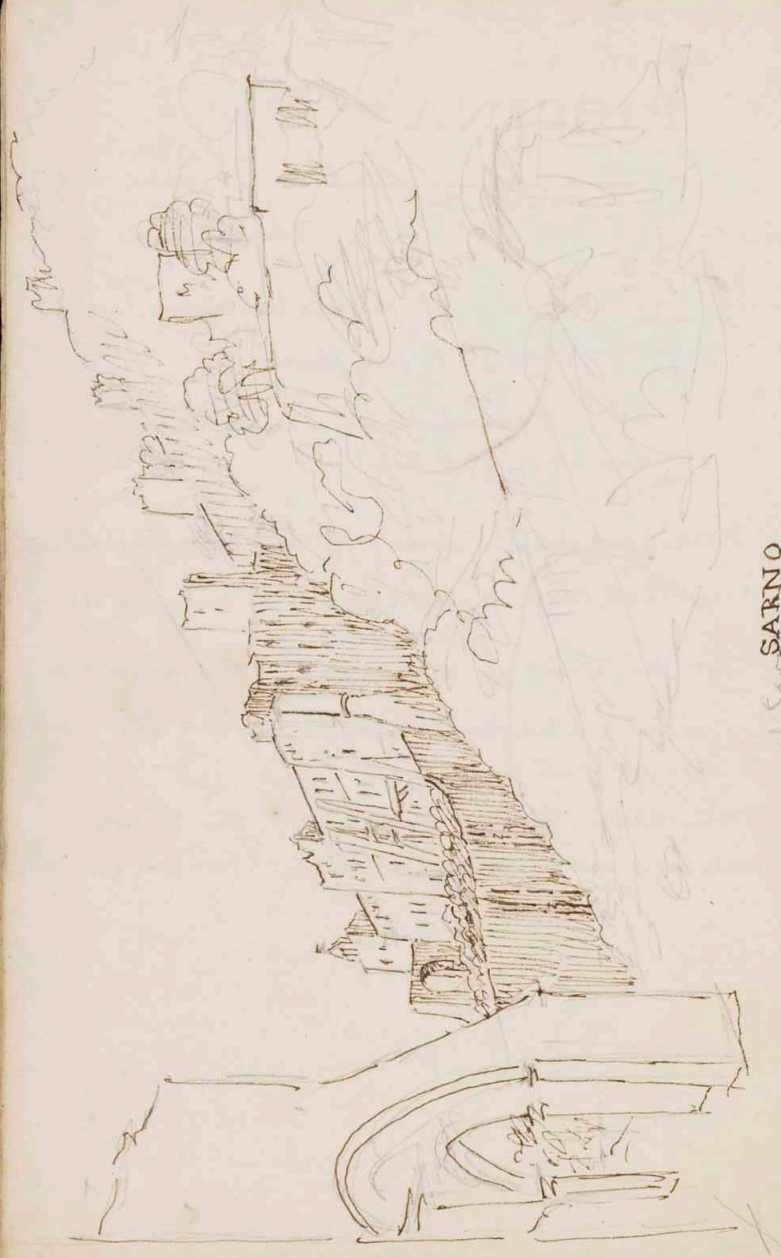

San SARNO

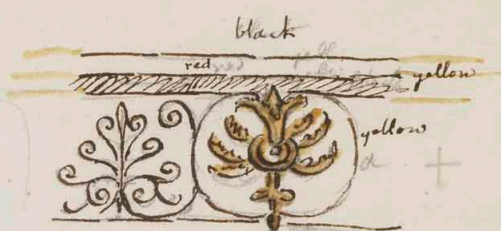

House of the Naviglio



House of Naviglio



Arch  
border }

Cold circular bath

Arch  
border

PISCINA



inner border

in case of arches certain black or green  
also on yellow walls but not very visible

water comes in at 2 ft high



TEPIDARIUM

Tepidarium & door to Calidarium seems to have been

3 Bronze seats one R & 2 on L given by

M. NIGIDIUS VACCILLARIS

Floor white, with one black border of 3 stones

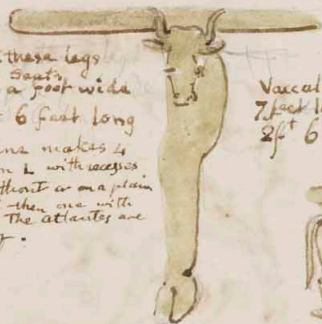

4 of these legs  
Seats  
above a foot wide  
about 6 feet long

M. Zane makes 4  
figures on L with recesses  
then 6 without on a plain  
red wall then one with  
recess. The atlantes are  
specimen of.

Vaccalar hearth is abt  
7 feet long by  
2 1/2 ft 6 broad



13 of these battlements



13 of these battlements

Bottom of hearth has bars of brass  
on which are bricks & then pumicestone

Over door to Calidarium iron nails & cramps for curtain?

Cold Bath

4 men pugilists?



next  
achiasiot No 3

PISCINA



R of door entering



10 over 3<sup>d</sup> Arch



left of 3<sup>d</sup> niche  
over 3<sup>d</sup> niche



after 5<sup>th</sup> man

close to 2<sup>d</sup> niche to R

next next a Chariot  
next a do over arch almost 2 goals

next over entry is



14



7 over 2<sup>d</sup> niche

Cost behind the baths 60 feet long portions included  
from the Calidarium to opposite wall



# Calidarium

hot bath 2 ft 1 deep

step inside 1 ft 1/2 inch. high 10 in. 1 ft 3 to lip.

lip broad 1 ft 4

Behind a sloping marble for backs of bathers. a <sup>step or seat?</sup> top behind it.

4 feet broad. long 15 feet. seats added to length 2 ft 2 in.

whole broad 17 ft 4. — long 3 1/2

2 steps to ascend from floor. floor has a hole on entering bath with pillars to support a moveable pavement to heat great bath water enters at left corner

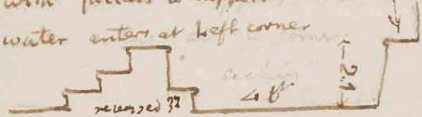

front steps

Vase or Labrum 8 ft 1 inches

Height to lowest cornice 7 ft 5 of room

70 inches lowest surbase high

floor little white mosaic with 2 black borders of 3 stones each — at  each

Vase for Labrum

CN. MELISSAEO. CN. FA. PRO. M. STALO. MERVFO. III. V. I. R.

ITER. ID. LABRVM. EX. D. D. EX. P. I. F. C. CONSTAT. HSD. G. C. L.

in the centre



The Vase is deep as this book

The floor suspended.

# Supposed womens baths

yellow pilasters — blue or black panels

floor white mosaic with black border of 3 stones 

inside room 20 ft square. vaulted. yellow walls & red pilasters. white above. Stufa suspended floors.

Piscina of women or.

Cold Bath room  wide 12.9 adding 1 ft & 1 ft 6 in for a wider part

The door to inner room is — 3 ft 2 in. wide

Bath 6 ft 8 in wide in front

7 ft 4 ~~ft~~ long from front to rear

Room. Whole 25 feet long —

Water course or spout outside. I think to carry water off the whole roof. inside people think they see marks of its being a cistern & a line which shows how high the water came ???

Third room. floor in part suspended? fire place or furnace for heating. at the further end is an oblong raised place which was a cistern ???

Cistern above womens baths.

end of Tepidarium



Tiles

TEPIDARIUM



opposite Gangræde

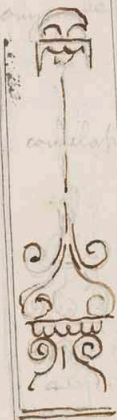

in Tepidarium

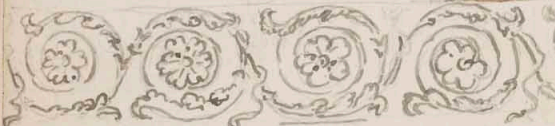

2 ft high



+



XII

many No<sup>s</sup> of marbles  
of this shape in  
Pantheon



under the piece of the  
Pantheon wall which I have  
already got

over my wall blue & a figure

## PANTHEON

Little Pedestals  
marble

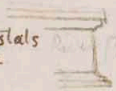

The Tholos paved with white marble slabs

North wall blue panels & pictures  
place of Musicians? R  
Court pebble work pavement.  
Columns plinths of Brass  
Painting not according to the  
2 great Forum doors

ΛΞΘΧΥ colloquium sceler  
et locus in quon homines  
de rebus philosophos con-  
sueverunt.



Private cells of Pantheon  
elevator in No. one the  
rather a door  
They had an upper  
story - their entered?  
only by a gallery.



## TEPIDARIUM



← 4 feet →

3d from door of Calidarium

• 11 near on left side

Arch Pedestal 1/2 deep joints Filasters 1/2 deep.

whole cornice 15.11" 5 8 9/16 wide at arch end and angle included  
4 joints 14 on Right side angles included → 2 sections one 8' 10" high of door

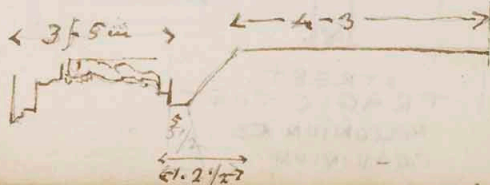

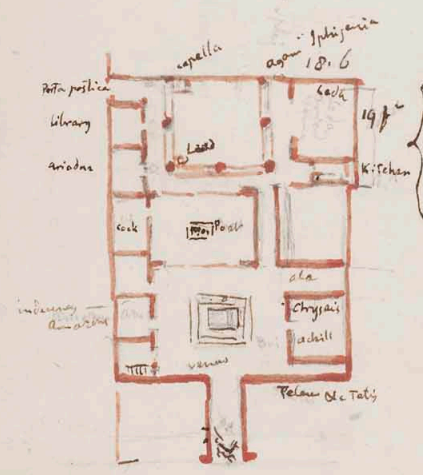
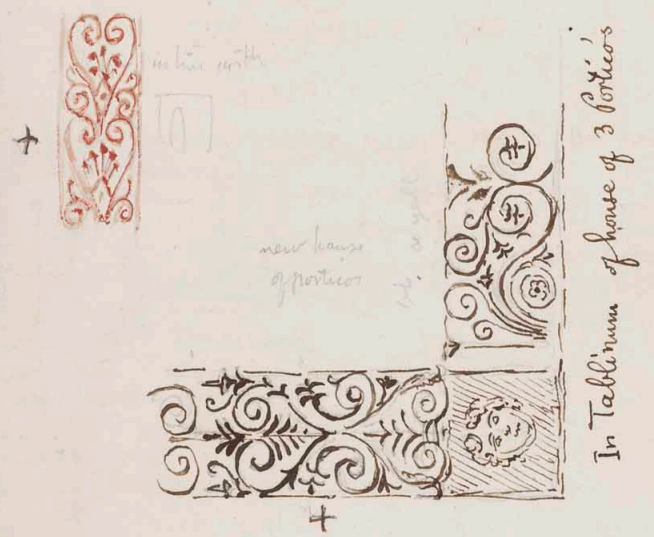

STREET  
 TRAGIC POET  
 HOLCONIUM AED  
 C. GAVINIUM

Pavement in Vices  
 of Tragic Poet 3, 9 wide  
 windows 1 foot 11 wide  
 red panels 4 ft 7 high

For the isola of Baths plan of  
 72 40 angle 12 feet from corner of Bath at west of Fortune  
 with Forum R. gate 81 20 angle 30° 20' at Arch of Fortune

Behind arch **L. VERANTINIUM. HYPSAEM** of Fortune  
 M. REF. M. M. P. M. P. M. P. M. P.  
**CASELLIVM. MARCELLVM**  
**AED. OPTIMOS. COLLEGAS**  
 nearest Arch **L. MARCELLVM. AED**  
**ALBVCIVM**

on each side entering arch of Triumph near T. Fortune is an  
 inscription of Fruit-sellers

on Tragic Poets house  
 + **M. HOLCONIVM AED**  
**C. GAVINIUM**

Canis ingens catena  
 + vinctus, non longe ab  
 ostiarii cella in pariete  
 erat pictus, superque  
 quadrata litera scriptum  
**CAVE CAVE CANEM**  
 ambiter Satyrico



STREET

In Chalcedicum marble sills to windows between Portico  
 & crypt. They shut thus - +



lock

DOOR ENMACHIA

not + { on East side of Chalcedicum  
 LOLLIVM ? why  
 & 20

Birds  
 Volutae &  
 Volubiles  
 Versatiles.



V. II. III. IV. V. VI. VII. VIII. IX. X. XI. XII.  
 M. N. O. P. Q. R. S. T. U. V. W. X. Y. Z.  
 III. M. R. F. N. R. H. A.

in red, on stone near angle of house  
 of Fuscus



In Chalcedicum

The Chalcedica says Vitruvius should if possible be at side of  
 the Basilica - two ranges of col. The upper of less than 3 lower

In Roman provinces the prominent distributed corn - but corn was  
 present in pits. Antonius quotes by Vitruvius makes Chalcedica  
 thousand or more which in houses were storerooms,  
 Chalcedica a plant - called Chalcedica or Vano. Chalcedica  
 used by Antonius Ansonius & Hyginus as all eggs were



The pluteum above to hide people walking - from  
 those below Vitruvius.

in wall of crypt of Enmachia sigla fac facit as  
 aurelius enim bonum fac Paquium DV. 120



several of these in  
marble  
Chalcidicum

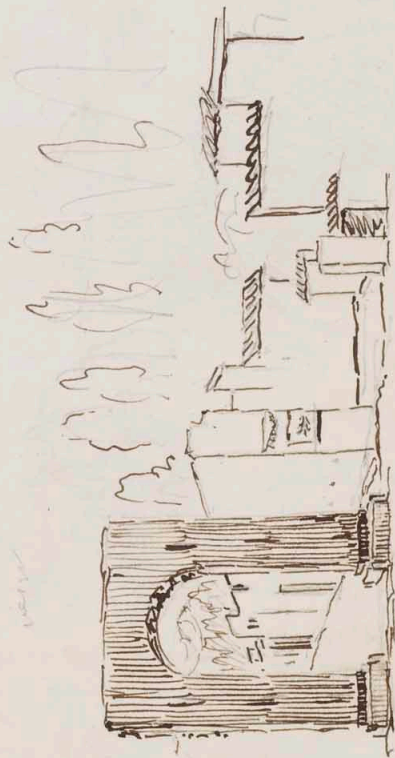

marble and limestone podium

marble base of Podium

note for restoration of T. of Fortune

S. of Mercury,

HARPY



Cavadium of Tragic Poet  
Left hand of Faux

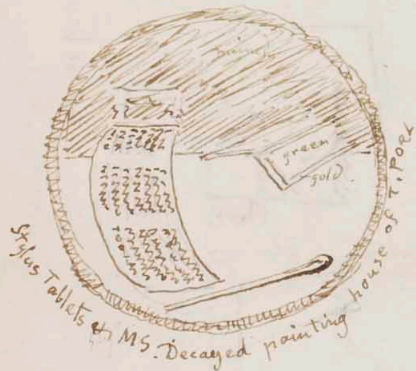

Tragic Poet



Faux of T. Poet



on black ground

Tragic Poet in the Faux

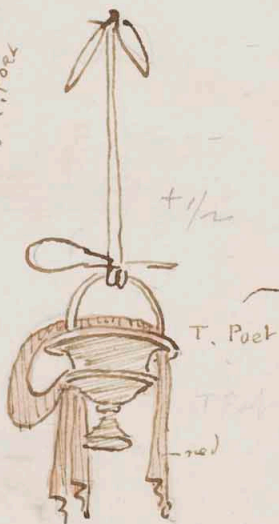

T. Poet

T. Poet

red

Pretty in the original +

T. POET



chamber in inner court of Tragic Poet

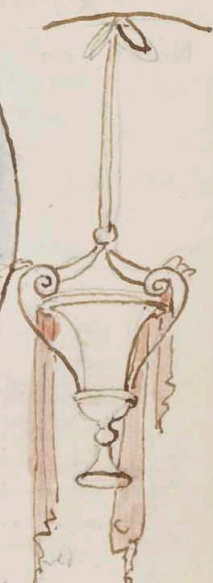

blue

blue

Red curtains

shield

Achilles picture 4ft wide  
4ft. 2 in high.

Iron rails between inner colts  
of Tragic Poets house

Ulysses & Diomed embark Chryseis  
for Chryseis - Children or Camilli of  
Old Chryses, or attendant boys -

are the Camilli of old Chryses  
or attendant boys

Picture L of Achilles

H of T. Poet.  
seems the greeting on a return.

subordinate of Chryseis



M. C. V. R. D O R F  
D. R. P. S. V. A. P. I. V. M. I. V. I.

Illegible characters cut in blocks of stone in the wall on right after passing the arch near T. of Fortune

Notes on Poets House

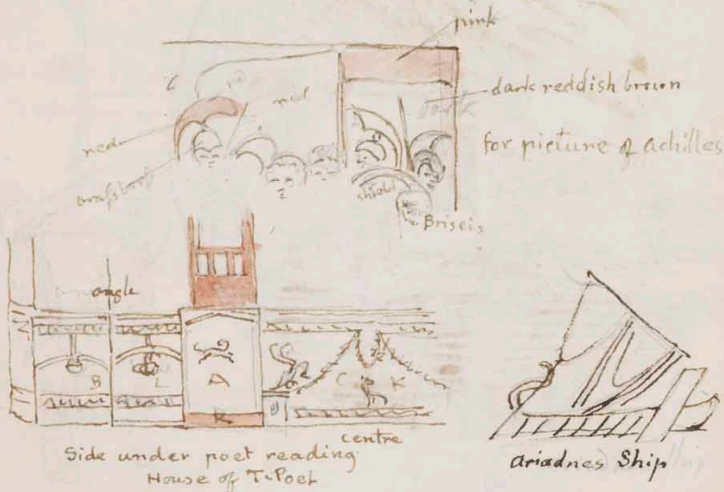

green blue glory man on R.

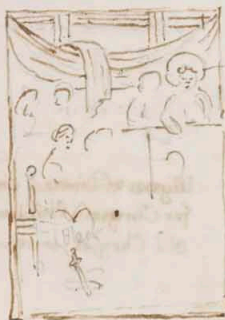

in obscure chamber Tragic Poet is Europa on the Bull.  
In Leda's room opposite Leda & Theseus quitting Ariadne's ship on R. Minerva in air on left Ariadne L. on ground with a blue glory in front entering Leda Venus & Adonis a beautiful Cupid Venus R. cupid leaning on her knee much ruined

Courtesans admitted to the symposium  
Dionysus & Ariadne among the subjects  
Xanthophon & Sappho & Sappho

Chalcidicum, a Chalcide urbe. 2 Banqueting houses at Chalcidicus amnis conitare amonibus.  
Chalcidica a chalky earth, conserving wheat. Sid. Var.  
Animatus pipas with holes for admission of wind. Hamatic V. I.

~~EVMACHIAE - L. F.  
SACERD PVBL  
FULLONES  
on base found Feb 1870~~

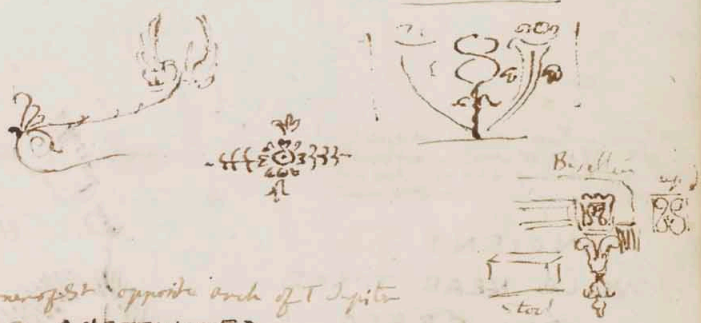

at corner of opposite arch of T. of Fortune  
on R. head A. VETTIVM ED  
M. SAMELLIVM

2 men carrying a vase in sight

In a sort of arched cellar newly excavated 1826 opposite the scavo of Lucina (Ludina) were found 4 gold rings, 6 silver spoons a pair of earrings, many gold & silver coins & the skeletons of 1 or 2 persons

ANCIENT  
VILLA NEAR TORRE  
DEL GRECO  
excavated by the Princes.

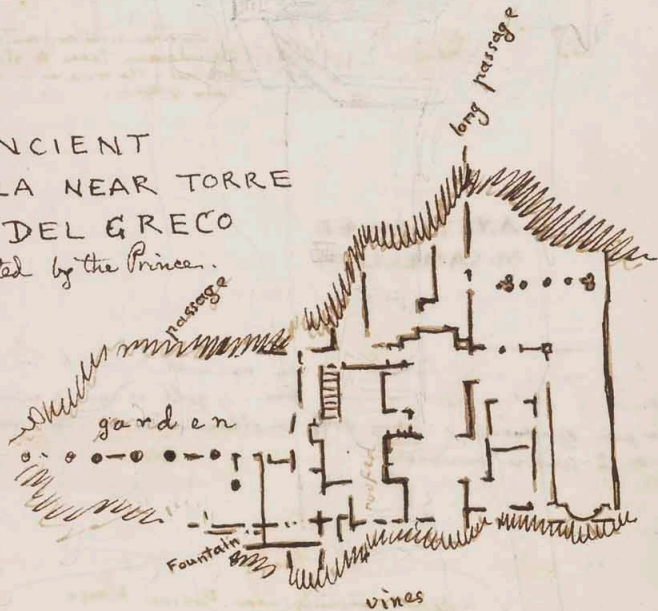

SEA  
NEW VILLA  
near Torre del Greco

In October 1826 the first of arch of fortune being continued  
many short inscriptions L. ALBICIVM &c found on walls.  
In the house with Panchinella & fountain a <sup>Herculaneum</sup> ~~Herculaneum~~ <sup>house</sup>  
with the same in country was a cauedium 50 feet  
by abt 40, & beyond Tablinum in which pretty good  
milking painted a portico with 3 Corinthian col<sup>s</sup>?  
a pseudo garden & a fountain all in mosaic shells &c  
with a white marble cascade 2m

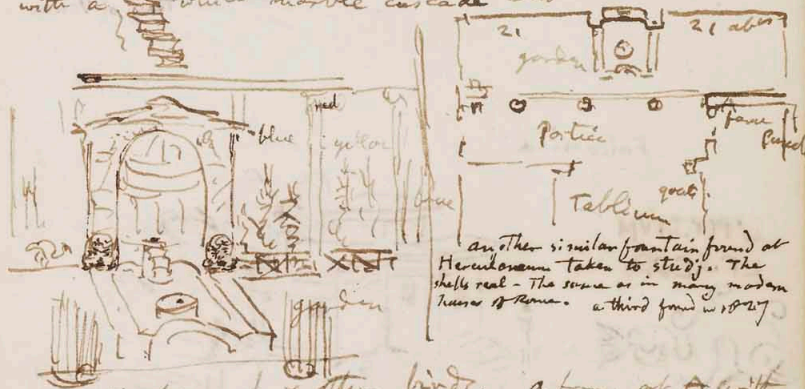

on wall peacock & other birds. a fountain at <sup>the</sup> ~~the~~ <sup>with</sup>  
a papyrus, red pilasters in pseudo garden -

De Goo make the 3 vases of bath 5 5 5  
diminish thus. In <sup>the</sup> ~~the~~ <sup>of</sup> ~~of~~ <sup>Fortuna</sup> all on R. of  
entry of Bath arched <sup>on</sup> ~~on~~ <sup>very slender walls</sup>  
therefore all the <sup>divisions</sup> ~~divisions~~ <sup>arched to</sup>

support each other. In <sup>the</sup> ~~the~~ <sup>stair case they</sup>  
contrary up to a sort of gallery where the <sup>shopkeepers</sup> ~~shopkeepers~~ <sup>had</sup>  
house of <sup>the</sup> ~~the~~ <sup>fontain</sup> ~~fontain~~ <sup>blue porcelain in glass</sup>  
a river god - circular. Very high cauedium.

De Goo says the little <sup>three</sup> ~~three~~ <sup>Baths</sup> ~~Baths <sup>arched over -</sup>  
probably was indeed certainly near Pansas house~~





Fulonica



Temp. of Venus

L'PORIDIVM  
L'F.AEDES

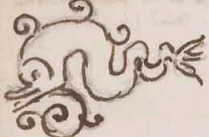

in T. Venus

In Tablinum of new 3 Portico House  
1828



new 3 portico house 1828



on Chalcidicum E. side in Lanz

LOLLIVM AED



This also Roof No 2



mouldings of the perfect door in  
the strada dei Mercanti

3<sup>d</sup> stone arch

1011777

NIX

101  
1011777

notes for the Door  
view



monkey  
at  
door

inscription of Via dei  
 Mercanti March 1827.

Λ ΙΟΙΙΙ·V·K·N  
 ΖΙΝΙΟΟΠΕΡΤΙΕΖ

in 1828

ΖΙΝΣ



Siren in the house of  
 the new fountain  
 1828

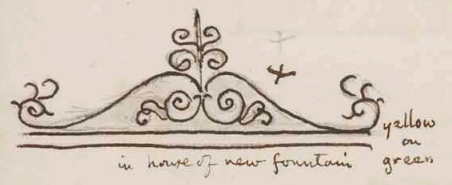

yellow  
 on  
 green  
 in house of new fountain

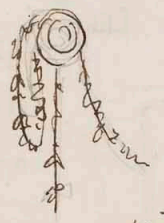

new fountain



new fountain

and

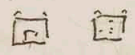

Painted pillars with rails  
 on which birds or jesses of garden

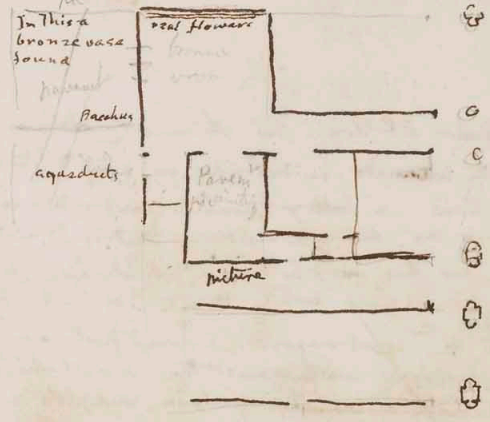

Street of 2  
 Triumphal  
 Arches

house of Bacchus

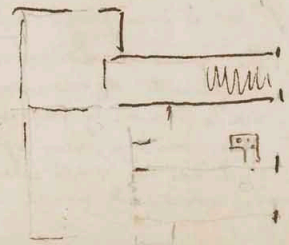

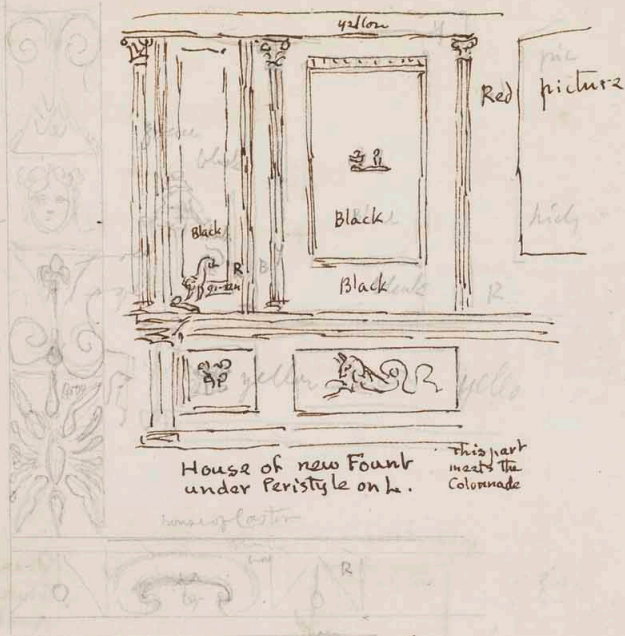

Fountain

in house of Diocianus



House of new Fount under Peristyle on L. this part meets the Colonnade

House called of Iphigeneia & Pollex. An atrium or laeodium. Turn L into a court with colonnade on two sides. no entry to Street wide place, a trichinium at E. end a bath & piscina in court with a central cistern for water. Here is the dwarf & monkey, and round a Medea very fine countenance. has the sword in hand. two children on a sort of square block playing. - wall looking through door at her - Have a door into the court on garden. broad portico - between pillars  a door wall against the vicolo behind. Wall painted as garden with arches trees fountains. grass plots & piscina. an ediculae against wall. a passage to vicolo from this garden a portico?  here. Scenes from plays painted. In Tablinum between garden & the great caecidium on entry of this part of house. Achilles in armor with Agamemnon, Achilles detected by Ulysses at Scyros. - apids drawn by jasons &c - Penelope in a divine sort of boat fine paintings. very lofty room in the outer court or caecidium which has red Doric columns were two chests fastened to floor & wall wood covered with bronze - money in these -

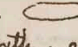
In the streets many of the curb stones have been used before as is proved by holes for cramps -  stones or stepping stones very frequent - at door of Bath. on R. of the turn from Hare or eagle fountain tow<sup>d</sup> Pansa

CAMPANI . . . . . scratched on wall near Diocianus.

NUCERII . . . . .



found at 2<sup>d</sup> door on R. House of Fountain. door threshold marble slab

notes for the new fountain



on each side



centre of black panel

under wall

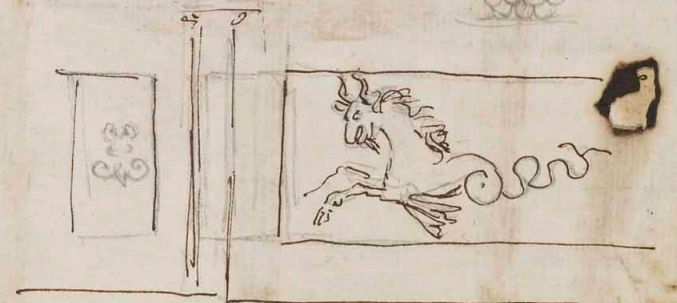



yellow

In an obscure chamber behind the shop of the Thermopolite opposite the house of the new fountain, is a picture of a drinking party sitting round a table much in this manner. There was a small chamber to retire to. Did a Thermopolion in general imply this kind of house?? This opposite a street a house of a Molestus.



In house of new Fountain

This house has like that of the first fountain a court with a broad portico. <sup>not</sup> a pseudo garden on the wall. The wall painted with the picture of beggar & child on R. Black panels under portico R. on L of fount picture with the man & hat  - on R lateral wall landscape with moles ports & porticos in the water - 2 small chambers on R of R lateral portico. in one this ornament near ground. R of Tablinum between atrium & inner portico a room with bricks painted. Game. chases &. The fountain has shells  so as well as the others -

A new picture 1028 in month of March had a dead body carried in a sort of Bier <sup>and covered</sup>. The head had a nail through it. This was in the street



effect of the pseudo-garden new fountain



note for picture in house of new fountain.

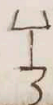
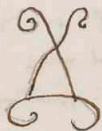
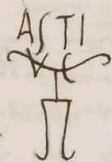
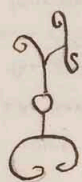

Signs of the Columns in court of the house beyond that of the Dioscuri. Col's are with Ionic flutes & Capitals as below

VRVSTI

CI

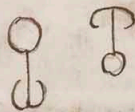

capitals

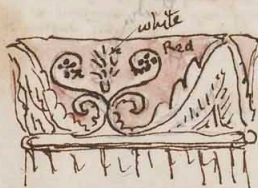

Picture in house of new fountain under Portico

opposite the nearest house beyond Dioscuri on Right of Door

M. CERRINIUM VATIAM

AED. DIGNVM REI P. TIRANNVS

FACIT

CVPIENS

SODALIS SECVNDVS

RVFVM

DIG. REI.

on house next that of Dioscuri

M. CERRINIUM VATIAM

AED. OS.

ET

on Cerrinius house next door

R. O. ROMVLVS

PRIMVS

ΚΑΡΝΤΙΩ



Θ. ΑΛΜΑΡΥΓΟΙΣΤΗ

on left of Door opposite the newest house beyond that of the Dioscuri

CERRINIUM

AED. TIRANNVS. ROG

ROMVLVM. AED

CASSELLIVM

SAMELLIVM. AED

LARINIS TVC

RVFVM

FANVS ROG

The house next & beyond that of Dioscuri excavating Dec 26 1828 - a peristyle with thin columns. Corinth capitals. Ionic flutes. many tiles in it

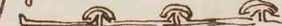

thus - & antefixes thus



FOUNT

In House of new fount. pretty marble front of steps to triclinium.  
water ran from mask in centre

on left was a bronze statue with fish in a basket, & other arm held  
on outre -

in centre on which a cupid with dove whence came water  
on R a marble statue same size as bronze a Caristis,

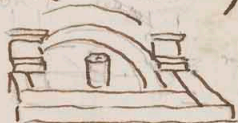

fount 5.7 deep fount .7 feet wide high square pint 7.7

In the Lupanare inner room 5 pictures on side  
indecent | Play of dice | complimenting | drinking scene | in detail  
          | people      | 2 men      | have it



Picture in the Lupanare N wall

In small room of Lupanare are 2 windows one with 2 wooden bars  
of one with an iron grate 2 inches square to South. in that some little  
room pictures chase of tigers. Venus fishing to west 10 palms square

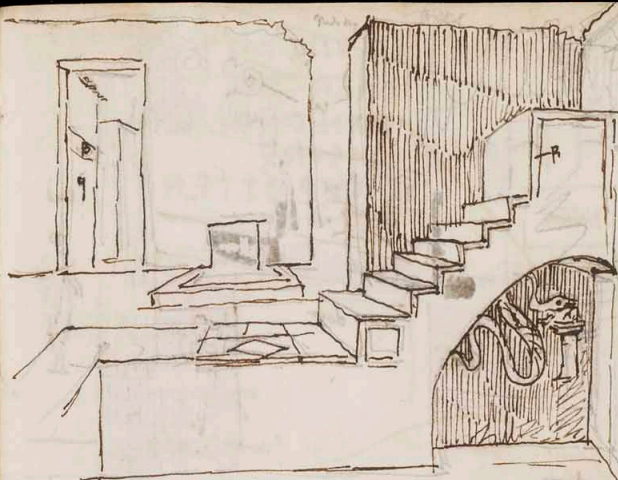

wine shop of the Lupanare. fount of Mercury steps for glasses

Portico of garden 16 feet wide HOUSE OF DIOSCURI  
19 long to Triclinium, by 16 feet -

Opening of Triclinium to N wall 20 feet. To S wall 25 feet  
pictures 2 on S wall of portico & the window of Triclinium of 2<sup>d</sup> court

1<sup>st</sup> Portico drawn by me near side 11 feet wide. Court 4 ft 9 to Vestibule of entry.  
whole wide door 7 feet wide in Vestibulum  
intercolumniations 2 feet. Impluvium 15 feet 5 square  
Columns red first drawn 5 feet 11 round about  
Cubiculum left of vestibule 8 feet 5 wide - 9 ft 6 broad. Bed  
place raised 2 inches, but the room is shaped

FORUM metal rails & gate shut up the portico in front of  
the Chalcidicum - Others shut up forum also - steps & blocks prevented

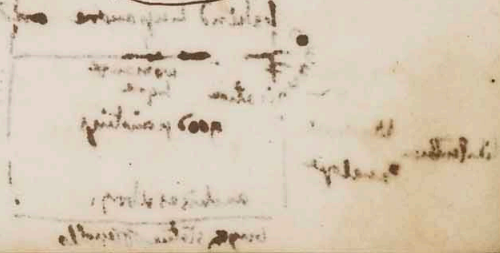



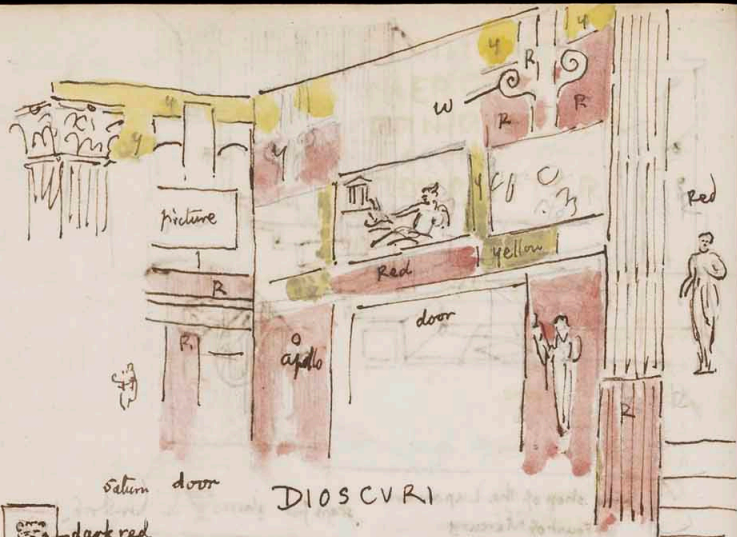

Victory of Trojan foot only 7 ft 6 wide  
without trotter. Trotter 1 ft 7 high  
have polygonal  
Winnings of cubituli 1/2 from trotter

Subjects in Chap 13

- 70 Drinking +
- 71 Mars & Venus
- 72 Jove of Rhea
- 73 inside of walls
- 74 20 of gate of Isis
- 75 Map
- 76 View of site
- 77 Pavements
- 78 do
- 79 Achilles dipped in Styx
- 80 Victory
- 81

in house of  
Dioscuri

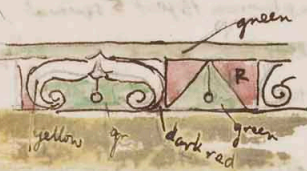

choreography scene  
behind Lupa and then room day for D. de Blora

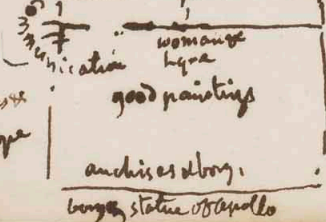

Paris a Helley like  
Harkins  
reitor looking on

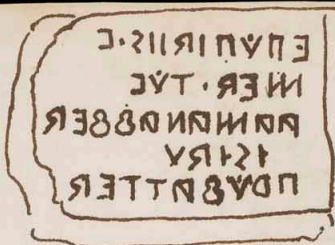

Gate of Isis

In house of Dioscuri already sent are

- 66 Jupiter 66
- 67 Andromeda
- 65 Court of Cisterns
- 60 Hygeia
- 69 Achilles in Scyros
- 80 Victory
- 56 Monkey & Dwarf

chariot & goats Vig<sup>th</sup> 25

may be added

- + Scene with goats feet
- + Shepherd of Polybus
- Silenus & Bacchus
- Hercules Nessus
- Venus or Atalanta?
- Meleager & Boar
- Apollo Daphne
- + Penelope.
- Mars & Venus
- Boy & water vase
- Castor & Pollux
- Bacchus young.
- Man & horse
- Diana Endymion
- + Saturn

Borders &

- Narcissus
- Apollo
- Fawn

ΕΠΟΜΙΡΗΣ·Ε  
 ΗΜΕΡ·ΤΥΕ  
 ΠΟΙΝΗΝΔΕΒΕΡ  
 ΙΣΤΡΥ  
 ΠΟΒΕΠΤΤΕΡ

Comic scene with horses feet on white ground

Saturn on red panel

House of Dionsori, has on outside rustic work in stucco, between panels of stucco painted blue, supposed of the Aeneasston.

At the great door or on its jamb a Mercury running with his great purse. Niccolini, book calls the entry aditum with porters lodges. Pausanias mentions arch barbaric and opus signinum off. trivium.

Walls of fine polished stucco red yellow etc.

Dionsori with stars. Horace Ode XI & III.

Stairs in porters lodge to his bed perhaps in P.

17th aditum. N. Corinthian atrium through Doric. Vitor.

Compluvium - Columns of Tufo Macerino.

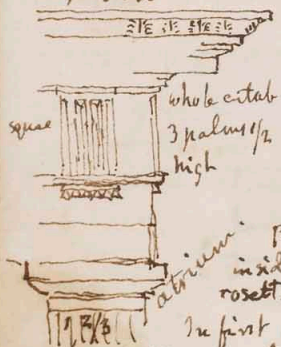

The fountain in centre basin of marble with frogs & lizards on it, with a key to open & shut it on lock.

At inter column opposite was a base for a statue. In the compluvium a aistyle with well of it on left, room with ropes white marble stones.

Pores of chests brick coated with marble inside brags outside iron, handles locks rosetts nails etc of bronze.

In first chest 45 gold 5 silver coins. ancients had excavated in room behind & made a hole through the wall & got most of the money. ||

atrine red & yellow panels. in zodiac flowers birds & a Jupiter sitting painted in this atrium. Victory Fortune Bacchus & four the panther pulls in robe.

a mosaic woman with sword & palm. Victory with crown S.C. which he says is difficult to interpret. Fragment of Mosaic & cock, only one all with a slab round it between the 2 chests.

R & left of Satyr & Horn asphodite laurel & little figures, one of Perseus who fights the victors of and rounded in a scapula. The other Europa & bull with eyes.

little rooms one perarvia, cellae domesticat, cubiculae.

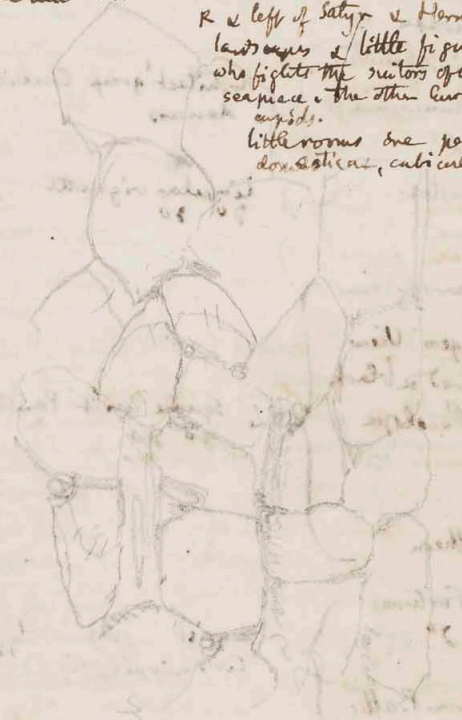

perarvia & traces of cubicles

Perarvia

R has a window to street, bed of the atrianses on custodia

PLATES

- 1 Frontispiece  
 2 General plan  
 3 Wall of border ⊕  
 4 another do  
 5 Red wall & windows  
 6 door of house ⊕  
 7 Picture behind Chalcedon ⊕  
 8 Stairs of Eumachia ⊕  
 9 Statue of S<sup>o</sup>  
 10 Forum pedestals  
 11 altar of Jove  
 12 Picture Mars & Venus  
 13 Pantheon gen. View  
 14 wall do red & black  
 15 Ulysses & Penelope ⊕  
 16 Asthra. now do ⊕  
 17 Muse  
 18 Cell of Pantheon  
 19 Plan of T. Fortune  
 20 View of do ⊕  
 21 Restoration  
 22 View of it from Baths  
 23 Plan of Baths  
 24 Gen. view do  
 25 Section  
 26 Court  
 27 Frigidarium  
 28 Natatio  
 29 Tepidarium  
 30 Roof of do  
 31 Calidarium  
 32 Section of
- head & Tail  
 Cupid & Mules  
 View of borders  
 Architect group Chalcedon  
 dancers  
 Circular vignette  
 do do  
 square pict. Pantheon  
 do do  
 Lyrist fig  
 Cornucopia fig  
 view in New fountain  
 O tower  
 sedant Apollo
- Preface vignettes  
 Flying fig. of Pantheon  
 Circular view of T. Poet  
 13  
 3  
 4  
 5  
 6  
 7  
 8  
 9  
 10  
 11  
 12  
 13  
 14  
 15  
 16  
 17  
 18  
 19  
 20  
 21  
 22  
 23  
 24  
 25  
 26  
 27  
 28  
 29  
 30  
 31  
 32

PLATES

- 33 Womens Baths }  
 34 outer view of do }  
 35 Plan of Post house  
 36 View of court  
 37 Restoration  
 38 Windows two views  
 39 Pic Achilles Brizeis  
 40 fac simile Achilley  
 41 Peleus & Thetis  
 42 Venus fishing  
 43 Ariadne & Minos  
 44 Post reading  
 45 mosaic  
 46 Iphigenia  
 47 Wall of Leda  
 48 Leda picture  
 49 Ariadne  
 50 Fullonica font  
 51 Picture in  
 52 Byres  
 53 Font of Shells  
 54 Comic Punch  
 55 Monkey disjunct  
 56 2<sup>o</sup> Fountain  
 57 Picture of Post  
 58 do do child  
 59 do hab. etc.  
 60 plan of this part  
 61 View of S. Mercurij  
 62 House of Ceres view  
 63 do of Dioscuri Plan dies  
 64 Court of do  
 65 Court of eastern  
 66 Jupiter  
 67 Andromeda  
 68 Hygeia  
 69 Achilles in Scyros  
 70 drinking scene lupanare  
 71 Wagon & horses do  
 72 Love scene  
 73 dream of Ahea  
 74 inside of walls  
 75 gate of Isis  
 76 general view  
 77 Pavements
- female Bacchantes  
 Bacchus  
 Group of Temples  
 Font of Mercury  
 dancers  
 do of Ceres  
 19  
 20  
 21  
 22  
 23  
 24  
 25 Chariot of goats  
 26 dance  
 should be better than  
 27 writing implements  
 28 altar of Asclepius
- 15  
 16  
 17  
 18  
 19  
 20  
 21  
 22  
 23  
 24  
 25  
 26  
 27  
 28  
 29  
 30  
 31  
 32  
 33  
 34  
 35  
 36  
 37  
 38  
 39  
 40  
 41  
 42  
 43  
 44  
 45  
 46  
 47  
 48  
 49  
 50  
 51  
 52  
 53  
 54  
 55  
 56  
 57  
 58  
 59  
 60  
 61  
 62  
 63  
 64  
 65  
 66  
 67  
 68  
 69  
 70  
 71  
 72  
 73  
 74  
 75  
 76  
 77

86 PLATES

- 78 Pavements
- 79 Achilles in Styx 70 D ⊕
- 80 Victory. 71 D ⊕

Addenda

- 81 View of wall of court Diocuri 72 D
- 82 Scene with horses feet 73 D
- 83 Shepherds of Polybus 74 D
- 84 Penelope sup. 75 D
- 85 Saturn 76 D
- 86 Hippolytus. 77 D
- 87 Faun

- After 69 of Achilles in Sappho  
 should be changed from 80 ~~70~~ wall of Tablinum 70  
 71 Victory 71  
 72 Penelope 72  
 79 — 73 Achilles in Styx 73 ⊕  
 74 Saturn 74  
 75 Scene horses feet — 75  
 76 Shepherds of Polybus — 76  
 Phaedra 77 Hippolytus — 77  
 78 Faun — 78  
 79 wall & door between courts 79
- changed from 70 80 drinking scene Lupanare 80  
 from 71 81 Wagon from S. 81 ⊕  
 72 82 Love scene 82  
 73 83 Dream of Rhea 83  
 74 84 Inside of walls 84  
 75 85 Gate of Dis inside 85  
 77 86 Pavements 86  
 78 87 do 87  
 76 88 General view. 88

Proscepi

Diana Indymion in O. 19 very fine. Narcissus & fountain also beautiful. Lyrisk flying, pavane & signum.

In central room O. place cubin wall to support bed.

Next room O. has finer pavement, mosaic.

room O left of 12, marble threshold & sides for hinges, in this shelves were a guarda robe, vases of bronze glass & a sigil in it. The door low & a window top, central court high up.

Opposite another room white marble threshold. hinges of iron cordine are remained. nuts, cedi, grain, figs - the storeroom.

a Plinth or seat in angle to match the chest of faun.

Tablinum contains a purple (Aulaca) white mosaic back borders. panni calceati with dancers on walls.

Figures above muse of comedy with pedana & reaspe

Other muse of Epopea with a pipes & ivy crown.

a third medilator apopogras - In Zocoli lens cantos

idge of goats etc. Pictures a landscape a man in a hat

offers a cup to another a bygon protate who carries a dog

ulysses returned to Ithaca, a dog knows him & c.

Tablinum is place for reception. Steps from faun

very narrow, to roof. walls too thin for mure-storij.

Choubonin faun a bed room. pictures of Ephebus & Provis

2 Narcissus in love with self in fountain. 3 Nymph caduets young Bacchus & Silenus

The lobler room a trichinura gant window. white mosaic ped.

Zocoli black with flying geni. above it architecture priests

patara vase. with animals & hunts. inter lobla.

Thetin bath of achilles. In blue ground the reclining Apollo

also a Naid on a Triton on water. may ruined

laur peristyle 5 columns Doric white 2 1/2 5. railing 5 palas

high. a xyntus or pergola to Right paved with Sigmurum.

holes for posts. ara & dedica to Bacchus. Panther on it.



house opposite that of  
the Dioscuri

projecting cornice in stone of house of Dioscuri  
toward the street

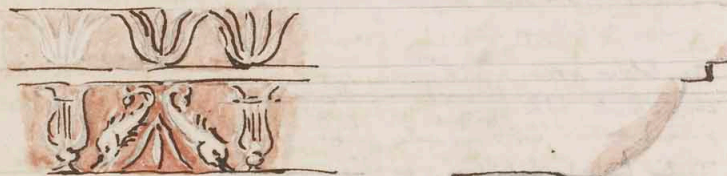

## DIOSCURI

Two paintings of scenes in peristyle. in zoculo red & yellow compartments  
and white birds following insects, flowers &c. walls in panels red yellow  
white black. Picture of Isis? ruined. Hippolytus angry with his  
stepmother declaring to possess a nurse who helps her to stop him.  
Picture in Tyotus of chapel & female with lighted torch.  
fruits - behind a river & fishes -

The great room an L of peristyle Barchi calls a cubiculum<sup>iii</sup>  
well painted red yellow blue, masks, putti etc. one with a  
goblet one with lyre. Masks.

Two pictures the damaged one in this book not likely Jo.  
The other Adonis reposing. with cupids & nymphs.

Kitchen. sink, stairs. fireplace & fortune painted. serpents tutelari  
genii of place. Dresser in inner kitchen & fovea in middle, back  
windows. pictures were here. other in w room cooks room with  
window to garden. not equally ornamented.

Corinthian cornt not noble part. gables arched???

Cupboards with animals painted on walls. Earth in court found with  
traces of planting as a garden. paschiera.

Great triclinium walls & pavement marble plating african &c  
slabaster. purple curtain pavement of court better here. great  
window to garden.

Servants house paved signino. Compluvium roughish tufo.  
in exhedra or ala opposite entry & pavement onyx & mosaic  
beds? R of entry a kitchen. separate painted, window over fire.  
a grille from this to a cloaca near it, an inner kitchen with doors  
& stairs, a window. beds for upper floor here to which the stairs.  
the two gables also ornamented. Fossleria q.

A. VETTIVM. FIRMVVM  
AED. V. B. O. V. F. FELIX <sup>EX</sup> C. OPT. <sup>AN</sup> <sup>AN</sup>  
Aulum Vettium Aeditum Vimbobum  
erat ut fasset Felix opt.

Morsum Holconium Priscum Aeditum Dignum Rei publicae Fucus facit

The first of these is the *Diocoria*, which is a small plant with a single stem and a few leaves. It is found in the mountains of the Alps, and is used by the peasants for medicinal purposes. The second is the *Diocoria*, which is a small plant with a single stem and a few leaves. It is found in the mountains of the Alps, and is used by the peasants for medicinal purposes. The third is the *Diocoria*, which is a small plant with a single stem and a few leaves. It is found in the mountains of the Alps, and is used by the peasants for medicinal purposes.

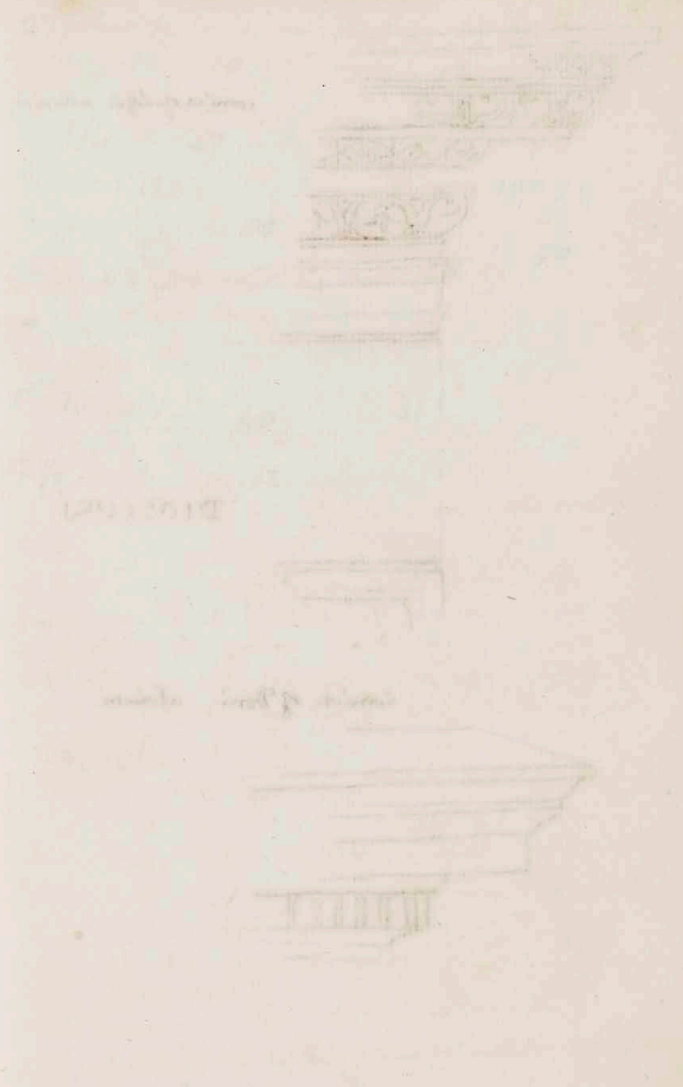



cornice of door

Dioscuri

mastic work

DIOSCURI

Cornice of Doric atrium

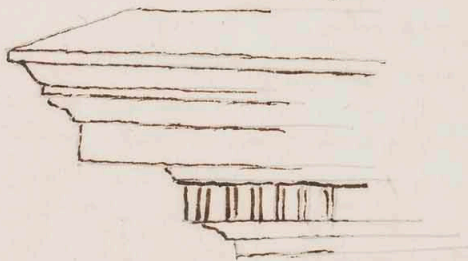

27 palms  $\frac{1}{2}$  wide great triclin by 34  
 whole portico 10 pal wide - 12 near triclin  
 piscina 18 by 21.

middle part 47 wide all by near 80  
 whole house 125 wide . 2 first houses 100 palms broad  
 The next inclusive 80

atrium 42  $\square$  or all 50 - gendar 25 by 50

18 wide whole peristyle -

1<sup>st</sup> Tuscanicum 40 pal by 31

17  $\frac{1}{2}$  completion of 12 cols in atrium

10	12
10	10
100	120
5	6
12   105 (8. 12)	126   10
86	120
1	6



DIOSCURI

DIOSCURI



HOUSE of the QUÆSTOR

In house of *Discursi Saturni*

Saturnus pingebatur ut homo senex prolixa barba  
tecto capite qui una manu scilicet dextra falcem  
tenebat. albrigi de deorum imagine.

Virgil. Vibisator curvam servans sub imagine falcem  
Saturnusque senex

Near a door with these hexagons  
in the Vicolo delle Mercurij.

M. CERINIVM  
VATIAM AED. OFSCA. P. SVS  
b1. MVSSS.

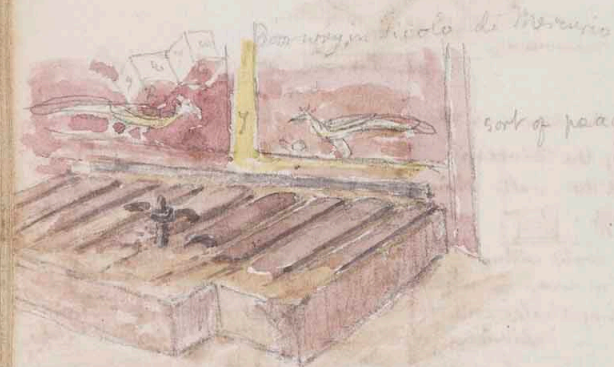
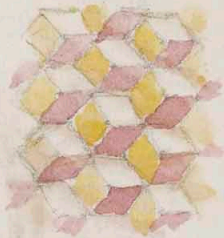

sort of paravents

The present remains of the money chest in the  
supposed house of the Quaestor or the Dioscuri  
at Pompeii.



in house of 2<sup>d</sup> Fountain +



At  
Herculaneum



wide



house of new fountain



Table new House of Pisciaria

FORVM

Portico near ~~Salcediana~~ shut with iron gates. Last pillar to S was to have  not finished next the old stone column which been taken away



DIOSCURI

battlements or ornaments on house top.



In the house of the new Fountain

In the house of the Dioscuri. the two chests for money do not seem to have touched the walls where the painting continues, but to have been 2 or 3 inches off.  perhaps fastened with iron bars to wall. Brass outside wood within ??, in centre an iron bar rises which held the top or cover in which a hole to slip money. probably opened by the magistrates with a key. — First court entered by great gate in Vestibule a rise then. On R a Kitchen seem to see a of a staircase of wood to an upper room above it. Holes in wall either for rafters of upper floor or for shelves for the kitchen one or 2 focalari in the room. the bed on L of entry a bed some inches raised (ie) the floor above the rest. In dec<sup>n</sup> all the trees a most of the blue paint gone from garden wall. Tablinum had the portico continued before it. Pilasters of Tablin<sup>m</sup> Corinthian capitals, but higher than those of corner pilasters of Portico the whole capital. Pretty mosaic floor in room to North, Great tablinum of Piscina court had no portico in front. Court paved red with bits of marble

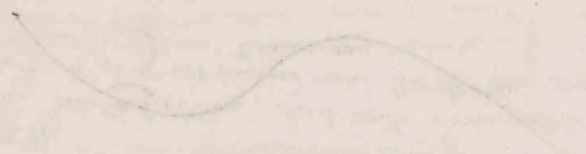

*Faint handwritten text, possibly a title or description.*



Largest Plate in Pompeiana

*Faint handwritten text on the right edge of the grid.*

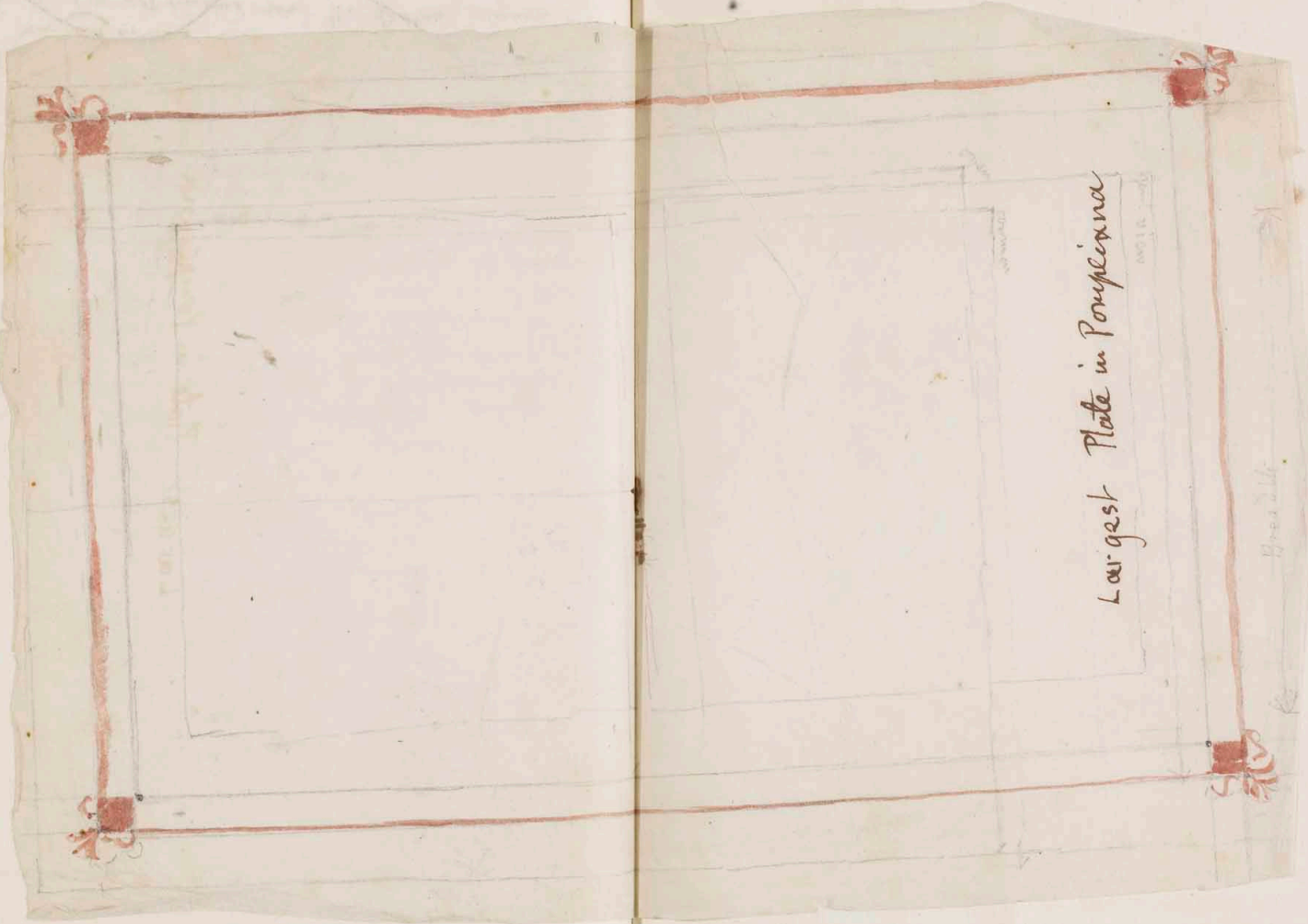

Largest Plate in Pompeiana

Brown & White

Handwritten text on a piece of paper pasted onto the left page of an open book. The text is written in a cursive script and reads: "Handwritten text in staff" and "resp. in J".

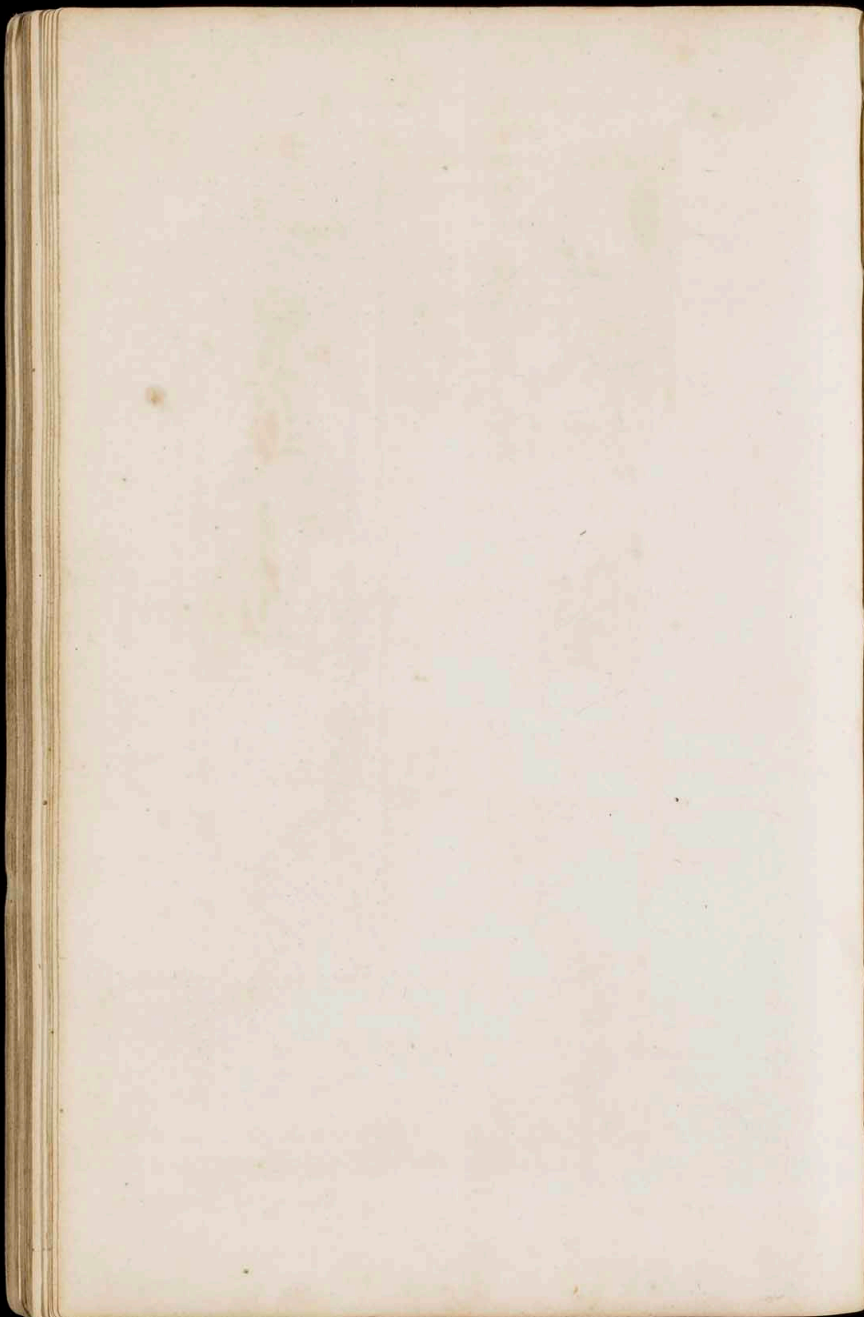

AT THE HERCULANEUM

end of Feb. 1829

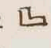
10 pillars with angles  long. i.e. 8 & 2   
at N. end & of which

the 2 centre square  
& the 2 others smaller.

Some on W have intercol<sup>s</sup>

S. H. Lushington

At North end the intercol<sup>s</sup> 8 feet 6 in.

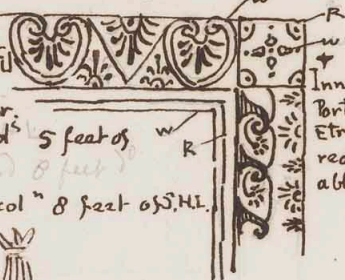

Inner Portico almost Etruscan being red & white on a black ground.



Portico 8, 5 wide

Col<sup>s</sup> 5. 8 1/2 round

4 ft 8 intercolumn<sup>um</sup> at SW angle

Columns high to architrave

10. 10

+ 10. 10

Inner Portico

B

court without Portico 13.5

30.0

Step 4 3/5 in

30.0

length of court 76 ft 3 inches

inner Portico

W

R

+



The colonnade on E. side upon with 2 gutters below.

That on W. lower & only on one step:



Inner Portico

+

All

In the house

excavated in

a. 1828 & 9

all the beams &

architraves were

perfect but carbo-

nized. In an

inner court on W

the irons for running

curtain rings between

the pillars

A picture in a species of Tablinum on N of Jo as a woman with short horns

The Shepherd sitting down

& receiving a Syrix





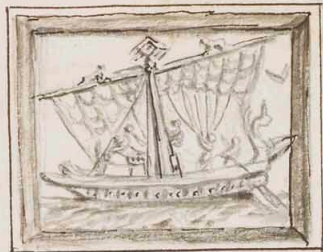

SHIP AT POMPEII

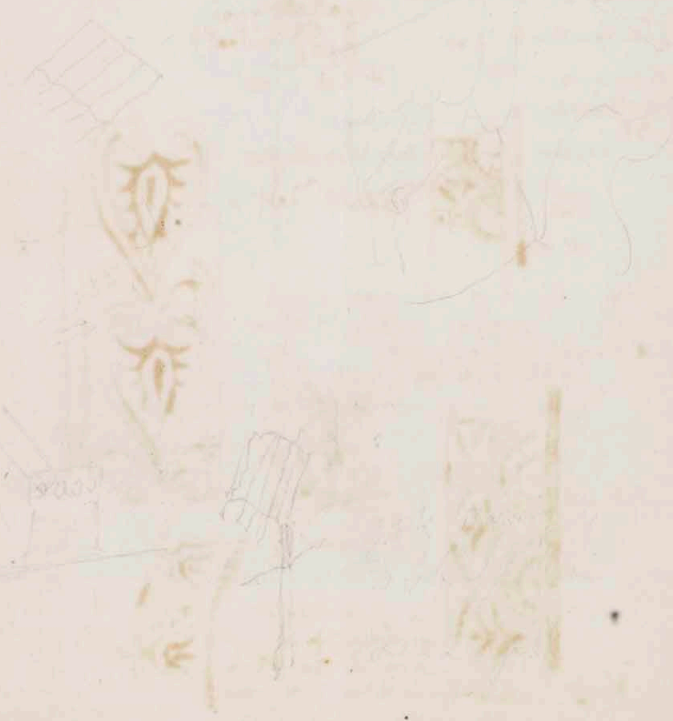

AT HERCULANEUM

July of 1820

to picture with capital D. July. 1820

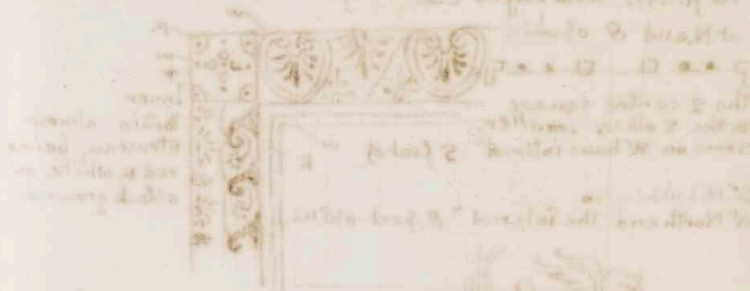

July 20  
 July 21  
 July 22  
 July 23  
 July 24  
 July 25  
 July 26  
 July 27  
 July 28  
 July 29  
 July 30  
 August 1  
 August 2  
 August 3  
 August 4  
 August 5  
 August 6  
 August 7  
 August 8  
 August 9  
 August 10  
 August 11  
 August 12  
 August 13  
 August 14  
 August 15  
 August 16  
 August 17  
 August 18  
 August 19  
 August 20  
 August 21  
 August 22  
 August 23  
 August 24  
 August 25  
 August 26  
 August 27  
 August 28  
 August 29  
 August 30  
 September 1  
 September 2  
 September 3  
 September 4  
 September 5  
 September 6  
 September 7  
 September 8  
 September 9  
 September 10  
 September 11  
 September 12  
 September 13  
 September 14  
 September 15  
 September 16  
 September 17  
 September 18  
 September 19  
 September 20  
 September 21  
 September 22  
 September 23  
 September 24  
 September 25  
 September 26  
 September 27  
 September 28  
 September 29  
 September 30  
 October 1  
 October 2  
 October 3  
 October 4  
 October 5  
 October 6  
 October 7  
 October 8  
 October 9  
 October 10  
 October 11  
 October 12  
 October 13  
 October 14  
 October 15  
 October 16  
 October 17  
 October 18  
 October 19  
 October 20  
 October 21  
 October 22  
 October 23  
 October 24  
 October 25  
 October 26  
 October 27  
 October 28  
 October 29  
 October 30  
 November 1  
 November 2  
 November 3  
 November 4  
 November 5  
 November 6  
 November 7  
 November 8  
 November 9  
 November 10  
 November 11  
 November 12  
 November 13  
 November 14  
 November 15  
 November 16  
 November 17  
 November 18  
 November 19  
 November 20  
 November 21  
 November 22  
 November 23  
 November 24  
 November 25  
 November 26  
 November 27  
 November 28  
 November 29  
 November 30  
 December 1  
 December 2  
 December 3  
 December 4  
 December 5  
 December 6  
 December 7  
 December 8  
 December 9  
 December 10  
 December 11  
 December 12  
 December 13  
 December 14  
 December 15  
 December 16  
 December 17  
 December 18  
 December 19  
 December 20  
 December 21  
 December 22  
 December 23  
 December 24  
 December 25  
 December 26  
 December 27  
 December 28  
 December 29  
 December 30  
 December 31





Dioscuri

+



House of Firmus  
Cavaedium - yellow  
on black

+

yellow



+

House of Dioscuri



+



in room. R of Triclinium - House of Dioscuri

more on a level

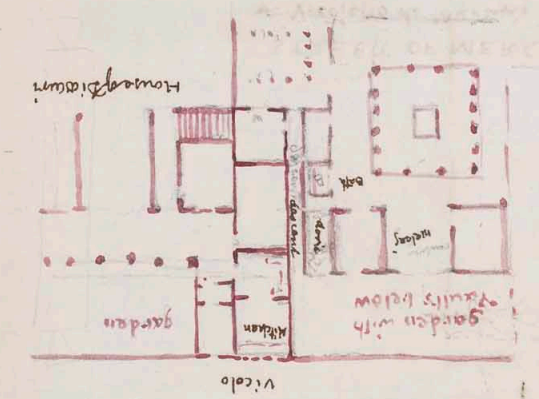
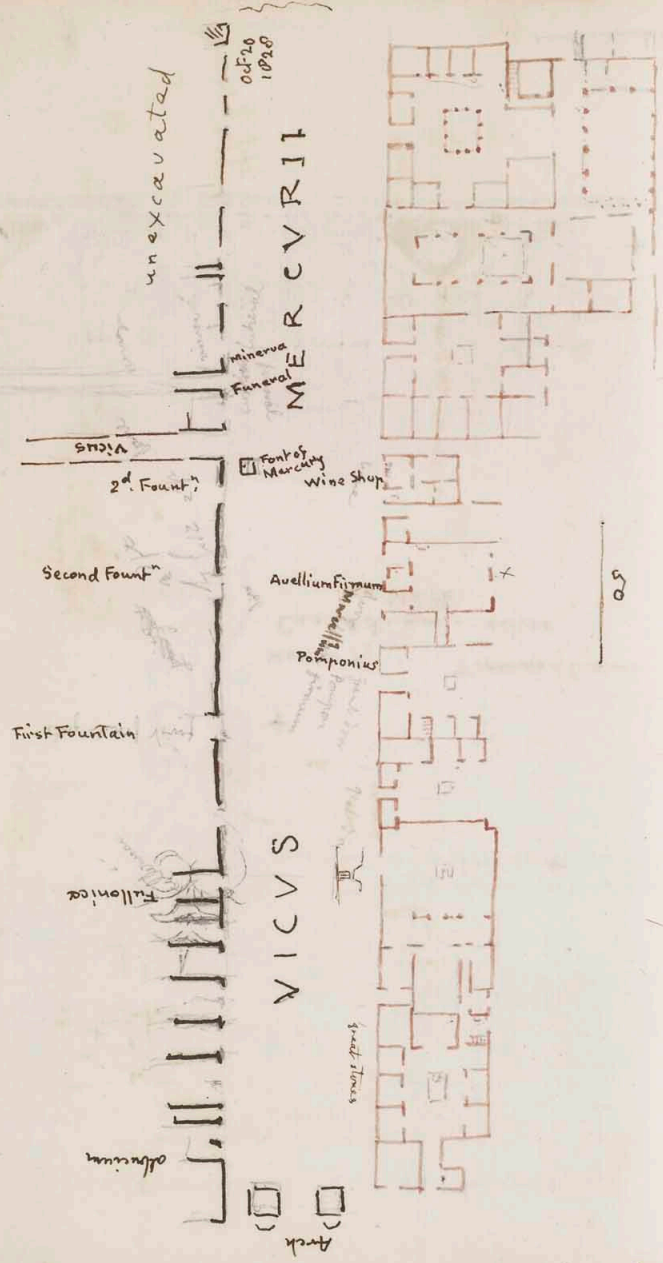

Inscriptions on lamps  
opposite the ~~vicus~~

CASILINVM AD

CERRINVM <sup>vicus</sup> AED. TYRANNVS. ROG  
SANELLS <sup>vicus</sup> 2

FANVS. ROG  
3 ROMANVM AED  
RVFVM <sup>vicus</sup>

on left of an  
opposite door

on Left also

M. C. ERINIUM V. AETIUM <sup>on R</sup>

AED. DISINIUM <sup>vicus</sup> REIP. TYRANNVS

on R. of an opposite door  
FACIT SEP SODALES

last new room of  
Dioscuri

Narcissus purple  
Worman green & lilac  
her lower gown dirty lilac  
blue basin

new room of old Pelus



in chamber  
L. of garden  
Dioscuri



In House of First Fountain,  
Tablinum

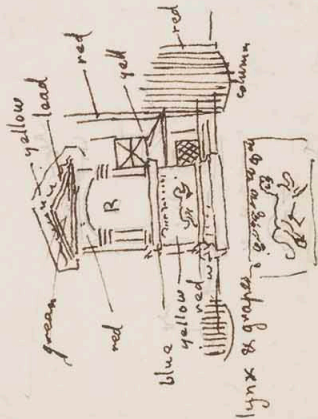

House of Dioscuri  
garden wall

BINDI on  
Garden Wall - Dioscuri

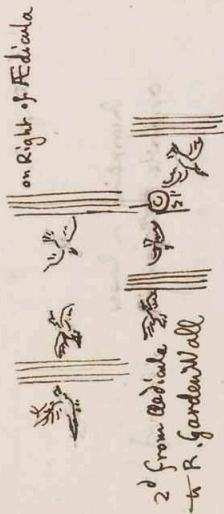

2<sup>d</sup> from Aediacula  
to R. Garden Wall

on Right of Aediacula

STREET OF MERCURY  
Vicoletto di Mercurio

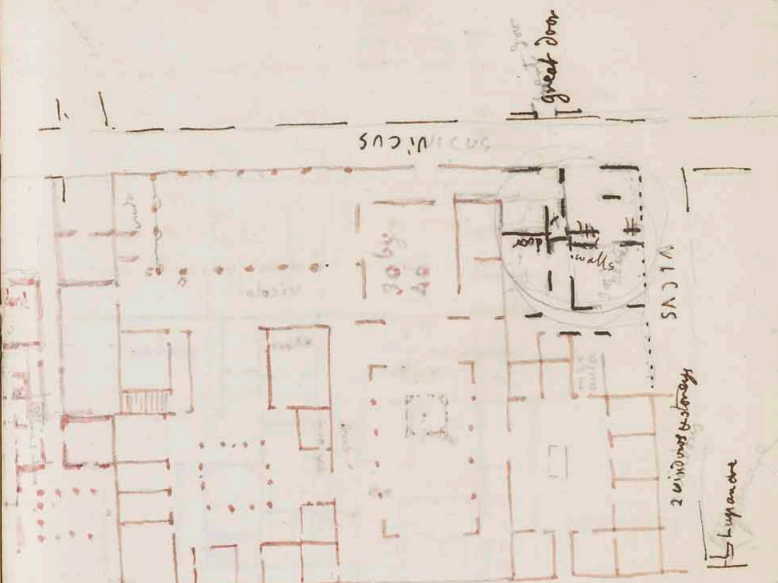
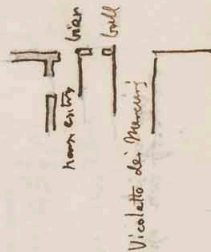

great door

SACRUM

SACRUM

2 windows

Luganone



Stone Wall terminating the garden of house of *fastor* Bellus —  
 The painted Cypress grove only on one side — porticos on the 3  
 others.  
 lower podium under garden portico black with lilies  
 & birds. 7 columns half red — Col's of Wall white

Portico of court black at bottom lilies & birds - Dioscuri garden  
 much red : pillars half red upper white 7 col ?

House of *fastor* *centra* or *stoa* in red

---

On stones of Emperor of Austria's Seals  
 large letters in Red. & Cicero

M. TVLIV

M. MARII

" " "

M. P. R. I. I.



in a small room house of  
 3 PORTICO'S  
 of Coston & Pollex



in house of Coston & Pollex

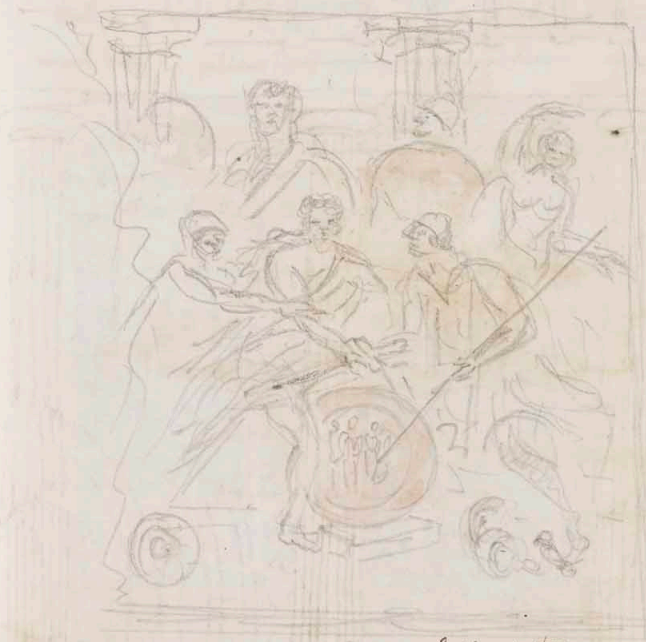

Memorandum of Achilles delecta  
 House of Coston



new in March 1827

in the house beyond the Fountain  
now 2<sup>d</sup> Fountain

in  
House  
of  
Fount<sup>n</sup>  
of  
Shells

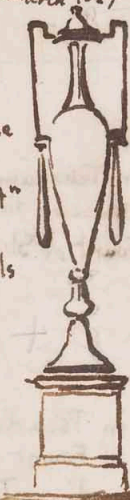

in House of the Fountain of Shells

Pilastres or jambs of door inside of  
room R of Portico in garden  
black with red & yellow divisions  
or flutings. Room yellow with  
red borders. Base & under window  
all red. 2 pretty female figures  
high up. Chamber of Punch

Every thing in same style - no extraneous beauty  
or vigor ever engrafted on decaying stock - Greeks only admired themselves, Romans  
only Greeks & Romans, no change in intellect stunted 3<sup>d</sup> century after X<sup>th</sup> work time.  
stagnant - like China. nothing learned or unlearned, paralytic legions.

Cornice on  
R hand of S<sup>t</sup> of Mercury  
but it came from the Palladian  
House of Leda & Bacchus



A  
double distance of this door

WALL OF ST OF  
MERCURY

this door goes to the  
garden copper gallery  
Twice distance of A from N of Fortuna

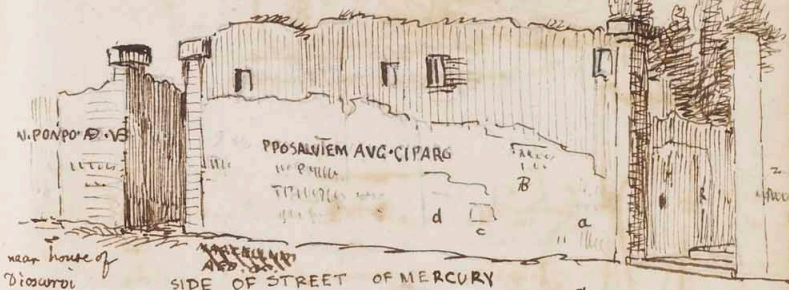

near house of  
Dioscuri

SIDE OF STREET OF MERCURY

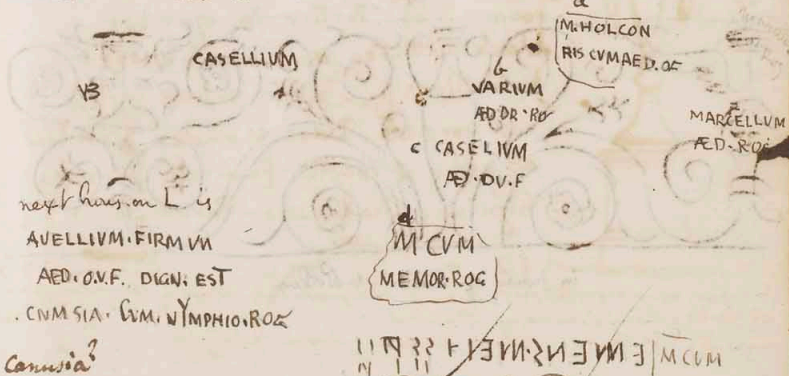

Conusia?

MOMIEMENMETHAETP

Andromeda in yellow  
Perseus in red



House of  
three  
Portico's



House of 3 Portico's

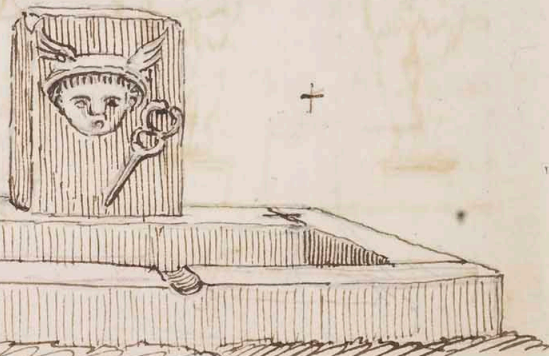

FOUNT OF MERCURY

st. of Mercury

March 28, 1927

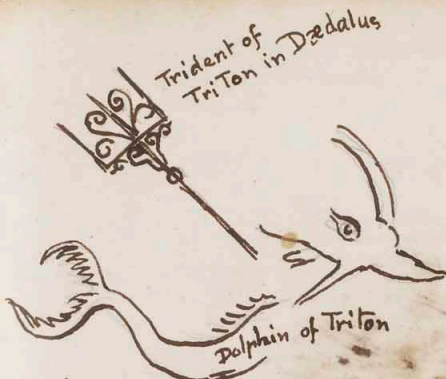

Trident of  
Triton in Dædalus

Dolphin of Triton



The 2 pictures of Helle in this chamber



See upto half head  
of figure on Ram

Thryxus has a red drapery

IN CHAMBER OF AMAZONS

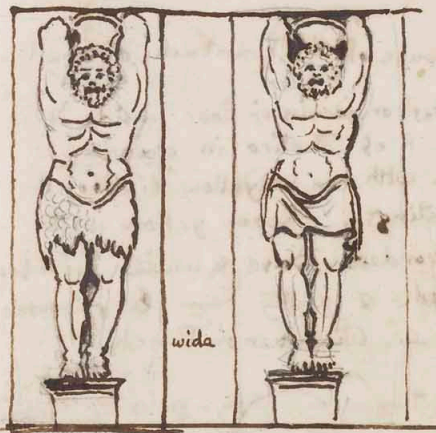

wida



in Tablinum of  
House of the  
Fount of Shells

Pillars in Pseudo  
garden of Fount of  
Shells & diameters  
distant

Tepidarium. Atlantee



House of the Fountain

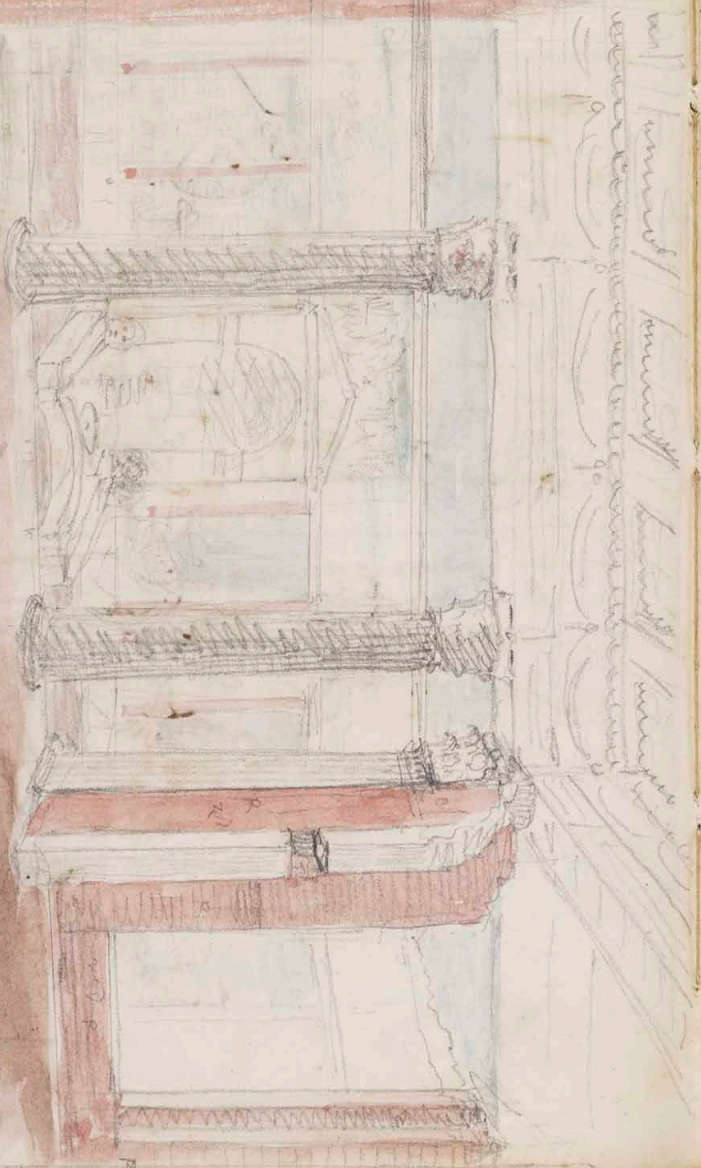

Handwritten notes in pencil, likely describing the architectural details or construction of the building shown in the sketches. The text is very faint and difficult to read.

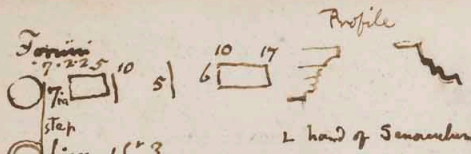

distances of pedestals from columns

Congius <sup>?</sup> other measures what  
at Fandi a Stone like this 1823

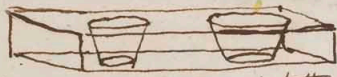

Public corn measure open at bottom

EDVZ  
C. CUSPID. D. PANSAE  
U. VIRI. D. QUART. QVING  
EX. ID. PEC. PVB  
Inscription on Right hand  
Pedestal in view



in S<sup>n</sup>. of Mercury,

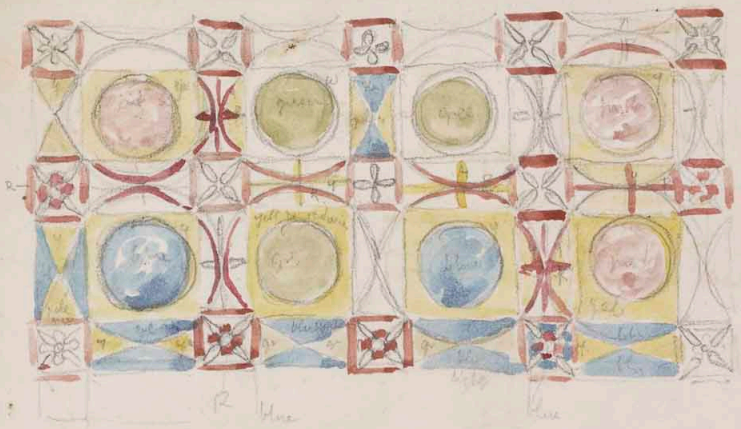

in house of Bacchus opposite Baths  
in this is the picture with male & female  
sitting at foot of Column

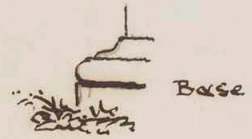
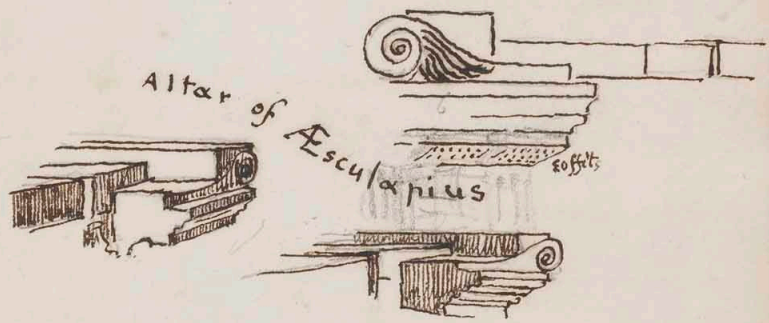

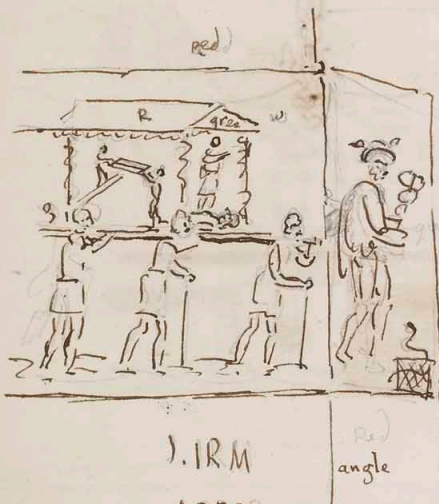

1. IRM

angle

AED:DR

in S<sup>r</sup> of M. enclosure

7 diameters almost high

Pillars of first Fountain

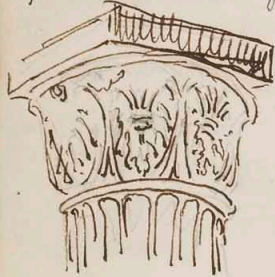

masks of Fountain  
have red hair



pillar on Right

flat.

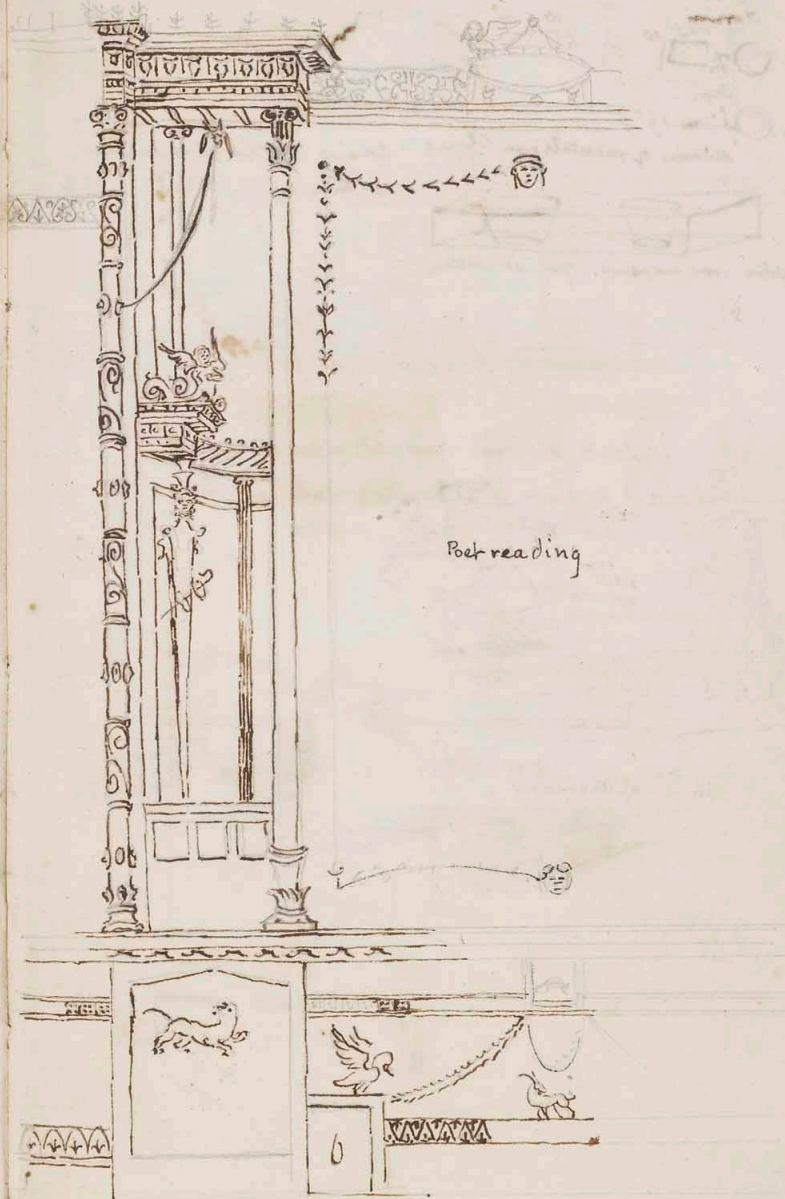

Poet reading

Tablinum of T. Poet.

CAVE CAN EM  
 < < o o o o o o o o o o  
 < < o o o o o o o o o o

real position of  
 letters & dogs feet



white Marb

A

umbilicus

slab raised 2 inches  
 above A

holes for fixing  
 wood

Door of Tragic Poet

Temp. Fortune

Temp. Fortune  
 4 steps up to altar

girones & then gate

Pilaster capital is  
 2 feet high



gate

15 rails 3 feet to rails  
 3 palms to edge

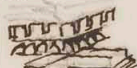

angle of soffit



Cell long 33 feet 8 inches

Pilasters 8 feet 6. centre to centre  
 on N. wall of cell

Corinth. Cap. 7 feet 11 inches

3 out of 4 pilastre  
 capitals remain in  
 front wall of cell

cornice

Leda

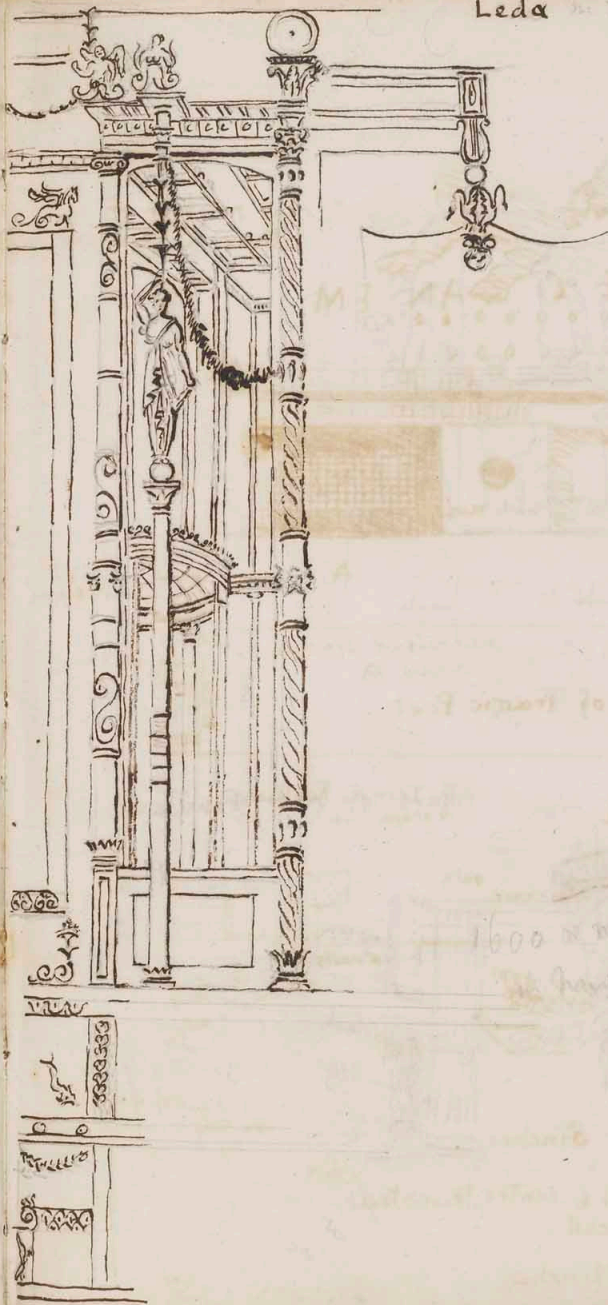

gallery on a wall

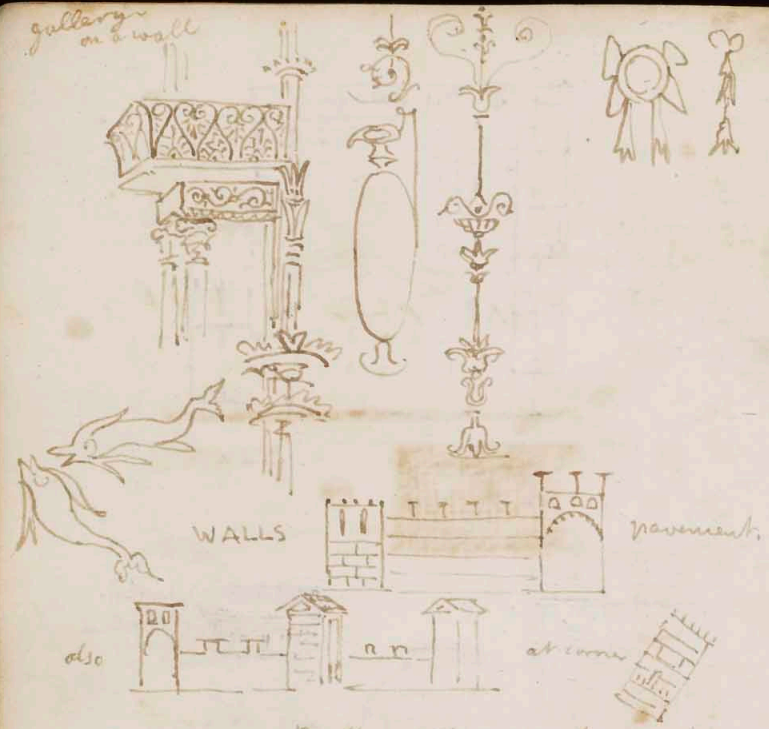

a picture with the valley or tower & gate  
 a pond & cow near a marriage in tent near  
 Chalcedian, various styles of it

The ocean inscrip &

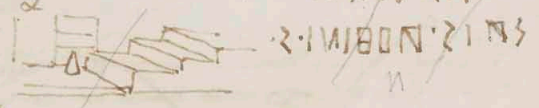

Strada mercanti



From Pal Morona Castell' a Mare

- 28 Scafati to Viheller - a end of boy
- 41 50 Scafati to Tormina top of quays & of Bonvicini & some masonry
- 46 25 Scafati Vicinia top of T. Annunziata
- 47 45 ~~Pal. della S. Maria Annunziata~~
- 52 T. Annunziata Vico 3 case
- 61 45 ~~Corona del M. S. Maria Annunziata~~
- 72 Torre del Geco 3 prints of ~~St. Eusebio~~
- 68 30 Scafati Casina ~~di S. Maria Annunziata~~
- 8 30 Scafati ~~di S. Maria Annunziata~~
- 12 45 ~~Scafati di S. Maria Annunziata~~
- 24 45 ~~Scafati di S. Maria Annunziata~~

Scafati to L. Palma

- 12 35 Palma ~~di S. Maria Annunziata~~
- 17 40 ~~end of M. S. Maria Annunziata~~
- 20 10 Scafati ~~di S. Maria Annunziata~~
- 32 + of Bosco reale
- 36 45 + other + ~~di S. Maria Annunziata~~

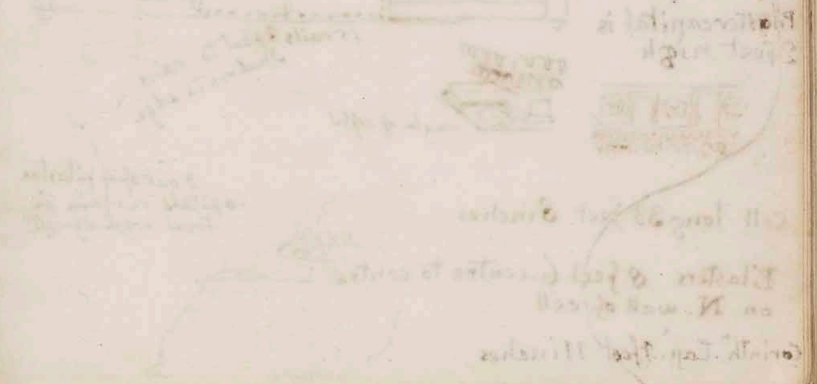

at gate of Naples porticulis  
 Han inn gate --- about 12 feet from inner end  
 The little gates seem to have no means of shutting.

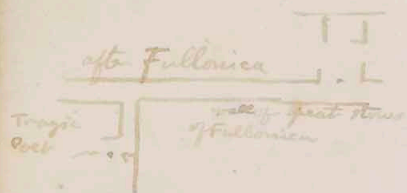

ΣΥΝΙΟΝ Π Μ

SAMELIVM comes  
 opposite Tragic poet's house comes  
 Vid p 115 of Comarci where it is  
 quite different



Fullonica

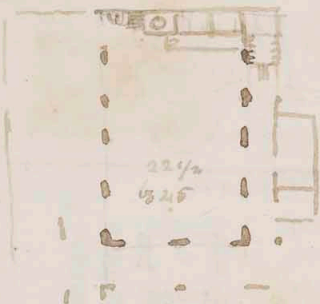

ΙΕΒΙ ΗΥΥΕ ΟΖΙΙ

ΙΝCΥΝDΟ ΗΗΗRΜΙΕΚOΣ

In Nov 1826 vases with olives swimming in oil found at  
 Pompeii - olives get coloured & with stalks. Oil burnt well  
 a vase of Tunny fish eggs on caudex in oil - The ashes had fallen in  
 & made a emul with the upper oil which preserved the rest,

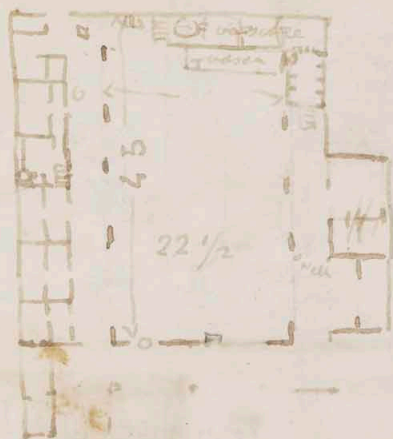

near fragments of  
 architecture built  
 of brick & stone.

Fullonica  
 Tombs



cloth  
 press  
 basin  
 on  
 either side  
 of central  
 part



well in  
 Fullonica

people bringing clothes to  
 wash - eye on side of  
 part - granular

anciently used  
 here in Fullonica  
 a pulley at least



Fullonica 1826

Pantheon  
wall of Pronaos



vid another of this

PANTHEON

in room of refreshments Pantheon  
Picture of Aesculapian with Kameles & Latus & Diana  
on Latin & Greek



water runs out from A & B into street

little window

On left of D entry from street of side wall picture of hatched, kang, boxes  
catches on Right side top, 5 steps to gutter base of fish

catches on R same, 5 steps, gutter  
above gallery the pilasters is on another stage pattern.

below painted (no)  
2<sup>d</sup> picture under wall has basket of food, eggs, fish &c.  
Bags of food, some hung up, bottles, boxes, &c. &c.  
see with room.



boats in any piece of  
wall, some on both sides

over Apollo sitting with adyca

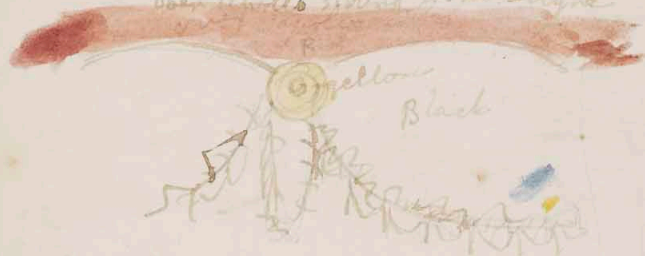

Vases in p



Pantheon

THERMAE

arranged by the great columns

3 great rooms of  
Baths & copper  
80 paces long,  
w. many vaults 6  
feet high  
at least 1000



section of the  
Dardanic tepidarium & Frigid  
cases



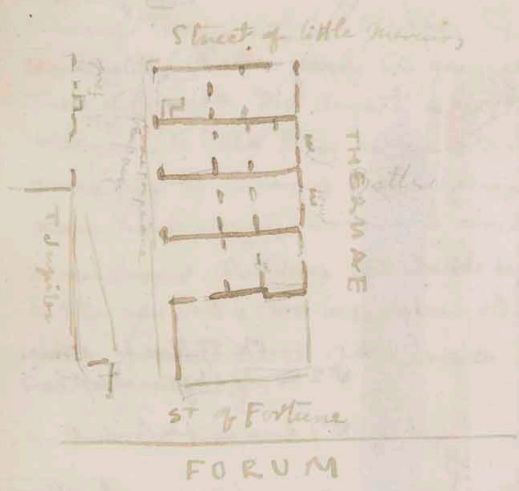

Gold pedestal near main entrance to Forum  
 master to Portico of ...

Chalcidicum gate  
 all open in ...  
 facade by 2 ... into floor

CHALCIDICUM

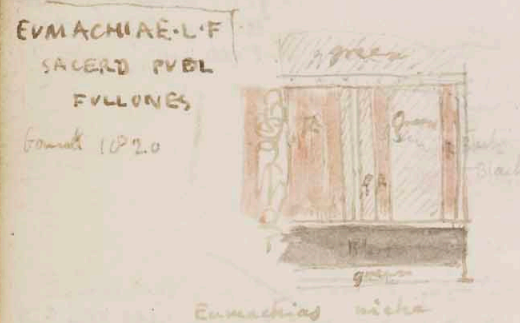

about fine  
 in all  
 architecton  
 &  
 frieze  
 Ionic above  
 this

60 broad  
 10 1/2 high



Division lines of valva

CELSUM on R g door PANTHEON  
 North from street of Fortune  
 On entrance L granite & marble  
 L plates & ...  
 a mill L of ...  
 on R large ...  
 great entry from Forum all marble ...  
 after ...  
 in the little division Phrygia & ...  
 in this of beams at about 6 feet high



many of  
 these  
 marbles  
 at ...

in kitchen ...  
 ...  
 ...



on R over a ...  
 ...



Papyrus - different kinds of ~~Pliny~~ Hist Nat Lib XIII. c. 11, 12.  
 papers of Tiborius & Caius Gracchus kept by Pomponius  
 secundus the Vates nearly CC years old. seen by Pliny -  
 Those of Cicero & Divi Augusti & Virgil saepe numero  
 videmus. he calls them monumenta.  
 Jerome says the library of Origen & Pamphilus at Caesarea  
 became much corrupted worn out in about 100 years,  
 in membranis. The Bishop of St Davids says the Alexandrine  
 MS in new brit is 1300 or 1400 years old.  
 Galen speaking of MSS of Hippocrates considers 300 years  
 as vast antiquity.

T. POET



Left of Fauc

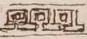

Of Pictures in atrium  
 No 2 has only 2 legs on left hand  
 on side of achilles  
 No 1 has a cupid & trident -

over achilles a little yellow stripe  
 then a band of mean ~~...~~  
 mean der is  

not this on black is  
 with  

basement of Bath is high  
 is a great volume a circular  
 vaulted; perhaps water  
 for Baths. S'g into Mercury

TRAGIC POET

Reasol on

1824 Bath excavated

basement of  
 Caedonia  
 rather atrium



On entering caedonia LR is the main  
 + of - tition Venus only legs on feet of leg. - drawing light blue feet  
 up by - head like Venus de Medici a dome on ground. first leg  
 over yellow a black pilaster. 2<sup>d</sup> picture on right wall cupid with  
 trident 2<sup>d</sup> picture only legs shoulder of amursons &

TRAGIC POET

the doing this room  
shut this window

Room L of Tab. Linnæi



Cock consecrated to Esculapius  
to Mars  
to Minerva  
to Sol

in Tablinum Tab



in Tablinum



in inner court between the columns



at end above one  
mel  
blue

in Cavedium



Peleus fine sandals

now called Helena's & Helen's  
on Thetis robe

on Thetis robe

Helena's robe



Venus L on entry  
flying drapery

first room on L yellow with black pilaster  
2d indians & amazon border

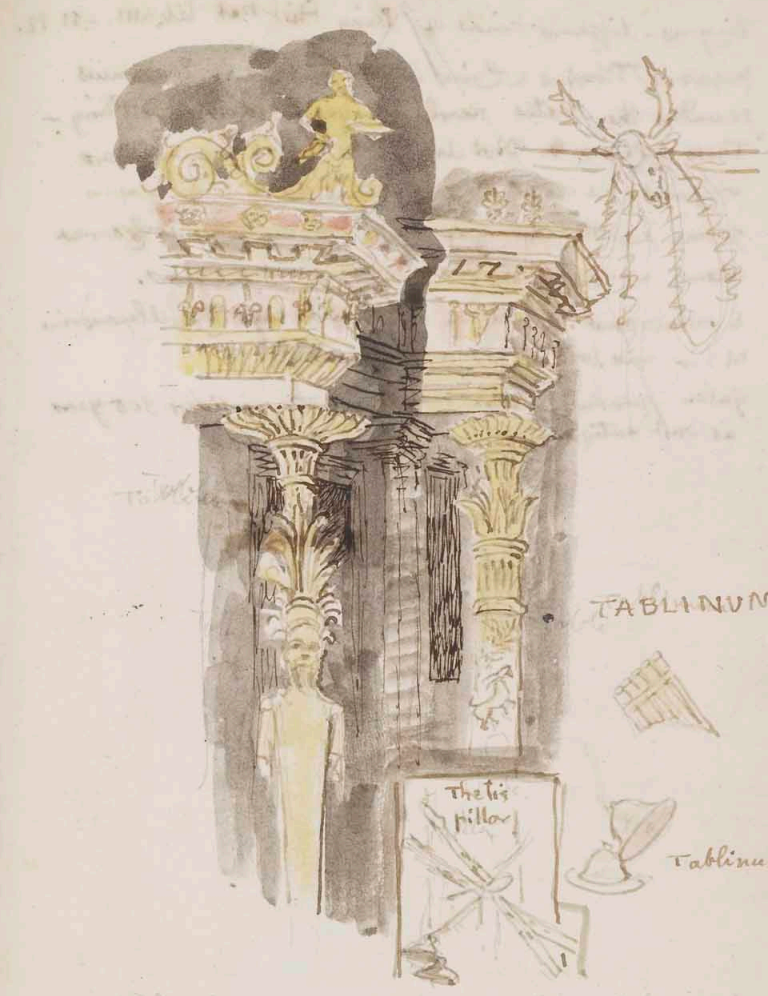

TABLINUM

Theis pillar

Tablinum

in Cavedium R is Peleus & Thetis, all the people frame rings  
Thetis has very fine drapery. Now called Helena & Helen's  
pillar in that picture has top pilasters, little boys on ground  
who are little satyrs or foot-pedlars. little boys on ground  
come on top of picture as children yellow & black with

Pullarica found 1825

Skeleton found under the stairs in Shogun's R. Room  
 69 silver & 100 brass coins by it.

Lida

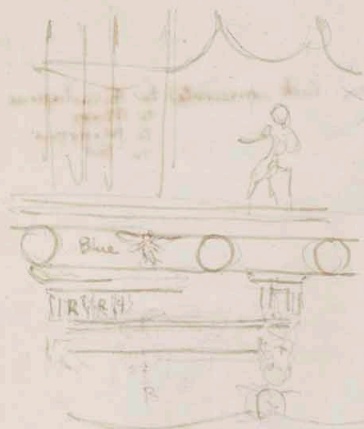

room R with 2 niches  
 & 2 bolt holes

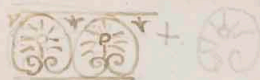

Shrine

little room ~~rooms~~ with 6 beams  
 about 6 inches thick each  
 windows of Arizone  3 palms  
 Wood frames, opened inwards



~~Urethane~~  
~~red hair~~  
~~pink robe shaded~~  
~~met~~



~~Namijans in Arizone room & Vasius fishing~~  
 room 12 ft high



names Pomponia Thai Herenni, T. Lucetius, Celsus  
Lucretia Vitalis are found in or near sepulchra of LUCIUS ARUNTIVS  
at Rome engraved by Trajan

PHILIPPVS. MELISSA. E.  
FAVSTI.

IANVARIVS. PIRICATI  
QVARTIONIS

IVCVNDVS. HOLGNI  
ANTEROTIS

AVCTVS. HELVI  
NYMPHODOTI Q

MINISTRJ. AVG  
VSSV

M. LVCRETI. MANLIA. N. I. NIBIENISTA. II. V. ID

L. EVMACHI. FVSCI. N. HERENNI. VERI. D. V.  
V. A. S. P. P

CN. DOMITIO CAMILLO. ARVINTO  
COS.

on a pedestal 1 palm 1/2 wide. 2 1/2 high of white marble  
in corner of court of house N. of Chalidicum. on the  
pedestal are 2 iron plugs. The court has 6 columns by 7  
& 2 baths

In same house painting of Mars & Venus. -  
a lime kiln near.

M. Plautius Hypsaeus Cos 125 ante X<sup>r</sup>  
inscript near ditch

HOUSE BEHIND T. MERCURY



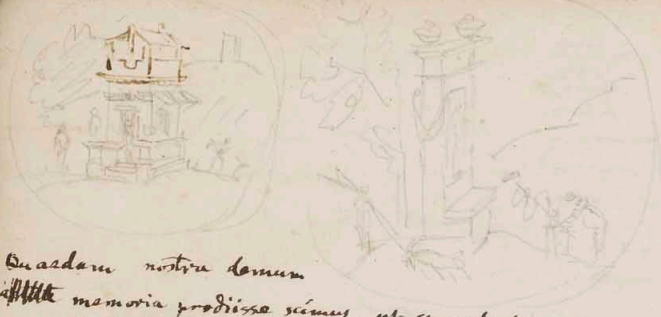

Quaedam nostra domus  
 memoria prodissa scimus, ut specularium usum  
 permittente testa clarum transmittantur lunam. Seneca.

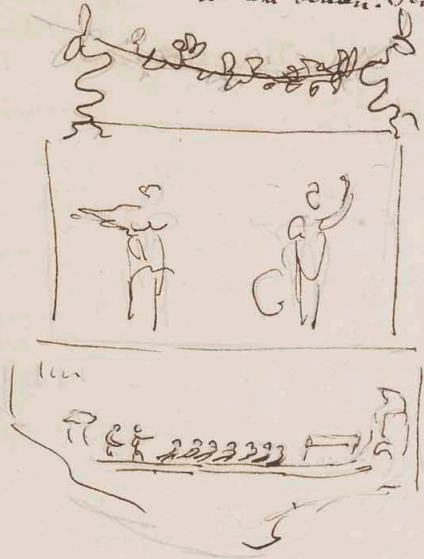

note for restoring wall on  
 Right hand of Arch of  
 Fortune.



From Top of Piscina

Tragic Poet  
 to unexcavated, natural level - "natural" <sup>tragic</sup> <sup>form</sup>

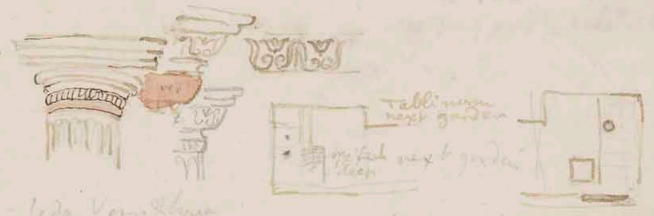
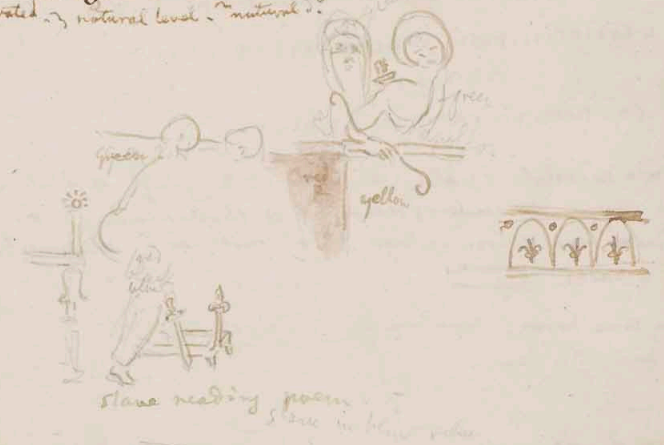

no doors next garden  
 visible if many of wood  
 applied to wall

two +

Frontispiece Fortune &c

No 1 Head piece



1 plan of new excavations

2 Wall of a house in Via Mercanti Library

3 Wall of stair case of Chalidicum

4 Eumachia statue in house behind Pantheon

5 Pedestals of statues in Forum Augustus &c

6 Pantheon in street view of Jupiter &c

1 Temple of

2 Wall of



No 2

Head piece & Cupids & Psyche

Althra

Penelope

Street altar of Jupiter

Temple of Fortune

Restoration

Plan of Baths

Tail piece Landscape Pantheon

Head piece

Cupids & Psyche

No 3 Section of Baths

General view of Baths

Frigidarium

Court

Piscina

Calidarium

Tail piece

- 1 Frontispiece Fortune &c
- 2 Plan of new excavations
- 3 Wall of stair case of Chalidicum
- 4 Eumachia statue in house behind Pantheon
- 5 Pedestals of statues in Forum Augustus &c
- 6 Pantheon in street view of Jupiter &c

- 1 pedastals
- 2 Pantheon general
- 3 Call of Jove
- 4 Wall
- 5 Althra
- 6 Penelope
- 7 Altar of Jupiter

- 1 T of Fortune
- 2 restoration
- 3 plan of Baths
- 4 Section of Baths
- 5 Gen view
- 6 Frigid

- Tail
- T of Fortune
- View of street
- Plan of Baths
- Section of Jove
- Gen view
- Frigidarium
- Court
- Piscina
- Calid

No 4 Head piece - Cave Lanem

- + Calidarium
- + Women's baths
- + Tragic poet
- + Restoration
- + Briseis
- + Iphigenia

Tail landscape

- No 1 Bath court
- 2 Piscina
- 3 Tragic poet
- 4 Calidarium
- 5 Women's baths
- 6 Plan Tragic poet

No 5 Head

- + Leda
- + Poet reading
- + Mosaic
- + Ariadne

Tail

- 1 - View Tragic poet
- 2 - Poet reading
- 3 - Briseis
- 4 - Iphigenia
- 5 - Leda
- 6 - Poet reading
- 7 - Mosaic

- No 6
- 1 mosaic
- 2 Ariadne
- 3 Fallonica
- 4
- 5
- 6

No 6 Head

- Nola gate inside
- Wall inside
- Theatre scene
- Wall of Fuscus
- Bonding of Fuscus
- View Fontana
- Tail altar of Esculapian

- No 5 Women's Baths
- + 26 Poet reading his work, with 2 Peaces
  - φ 27 Ariadne
  - φ 28 Ariadne & Theseus
  - new fountain
  - 30 picture behind it ?
  - φ 30

No 6 appendix

- φ 32 new fountain gate of Wola inside
- φ 33 picture behind it Inside walls
- φ 34 Boudoir of Fuscus
- under the scene of Theatre
- 35 -
- φ 36 view of the scene of great theatre
- Tail piece Altar of Esculapius

+ sent to Westmacott — φ his done — φ done not sent  
 + 2 dancing figures  
 + 2000

Head piece page 90 in my book 2<sup>nd</sup> Vol

- 7 1 Frontispiece . *Leathopora* with Victory &c composition
- 2 Plan new excavations
- 3 Wall of a house *St dei mercanti*
- 4 Chalcedium & *Umachia*
- 5 Street altar of Jupiter
- 6 picture in house behind Pantheon
- 7 View of Pantheon
- 8 Pantheon wall
- 9 Pantheon Temple
- 9 Tail piece page 93 lower & under —  
 and landscape head piece
- 2 φ 7 Picture from Pantheon 10. *Etetra* & Vulcan  
*Penelope* & *Ulysses*
- φ 8 View Temple of Fortune & arch 11
- 9 Restoration at 20
- φ 10 *Penelope* & *Ulysses*
- 11 View of *Argyria* & statues in No 6
- 12 — Plan of T. Poet house  
 Tail piece and picture landscape



No 3 head piece cave cavern

- φ 13 View of court of Poet house
- 14 Restored 2<sup>o</sup>.
- φ 15 *Briseis* &c
- φ 16 *Iphigeneia*
- φ 17 *Leda* wall
- φ 18 mosaic  
 Tail piece *Aphrodite* & *Venus* fishing

No 4 Baths

- + 19 Plan of Baths  
 head, lying compartment & boudoir
- + 20 *Frigidarium*
- + 21 Cold Bath. *Piscina*
- + 22 *Tepidarium*
- + 23 *Calidarium*
- + 24 General View of Baths excavation
- + 25 Court of Baths

Vignettes

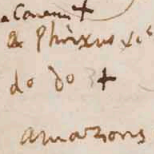
- 1 Cupid & Nudes 3
- 2  4
- 3  Vignette from Chalcedicum 5  
12 & 13 for 6 & 7
- 4 O in Tragic Post
- 5 Manuscripts 25
- 6 Cave Canem 15
- 7 altar of Esculapius
- 8 Pantheon landscape 9 +
- 9 do 10 +
- 10 dancing figures } for new set of chapters Chalcedicum -  
for the Preface For preface  
1 & 2 dancing figures }  
Chap VI 13  
14
- 11 do do
- 12  Vignette. To Chap 1  
3 Cupid & Nudes  
4 view & borders  
6.2  
5 Archilochus group Chalcedicum  
6  
Chap 3 view  
8 do do  
Chap 4. O view  
10 do do Pantheon  
Chap V or T Fortune  
11  
12
- 13  5  
6  
Chap VII Tragic Post  
15 Cave Canem  
16 Phryxus  
Chap VIII  
17 female dancer  
18 Bacchus  
Chap IX  
19 group of Temples  
20 Mercury fountain
- 14 & Phoenix do
- 15 do do +
- 16 Amazons do
- want Vignettes 11  
12 2

New views.

- 1 House of Dioscuri.
- 2 House of new Fountain.
- 3 View of St. of Mercury.
- 4 View of 2 courts Dioscuri

Pictures

- Peleus & Thetis
- Jupiter
- Picture in Fullonica
- Lovers
- Chap X  
21 dance of Mars & Venus  
22 do do
- Chap XI  
23 choros of gods  
24 do of figures
- Chap XII  
25 writing implements  
26 altar Aesculapius

Order altered thus

- Frontispiece . . . . .
- + 1 Plan of new excavations since last volume
  - + 2 Plan of the Baths
  - + 3 Section of Baths
  - + 3 General view of Baths section of do
  - + 4 Frigidarium
  - + 5 Court
  - + 6 Piscina
  - View from angle of Baths.
  - + 7 Tepidarium
  - + 8 Calidarium Laconicum.
  - + 9 womens Baths
  - + 10 View Tragic Post
  - + 11 do restored
  - + 12 Briseis
  - Peleus
  - + 13 Iphigenia
  - + 14 Leda
  - + 15 post reading
  - + 16 Mosaic
  - + 17 Bedes wall
  - + 18 Ariadne
  - Plan of T. Fortune
  - + 19 Temple of Fortune View - Plan
  - + 20 restoration
  - + 21 Pantheon view
  - + 22 cell of do
  - + 23 Aethra
  - + 24 Penelope & Ulysses
  - 5 25 Wall of Pantheon
  - + 26 Chalcedicum Eumachia statue
  - 27 no fountain of Dyer
  - 28 Picture at do behind
  - 29 - Fountain of Pomarii first fountain
  - 30 - Second fountain view of
  - 6 31 House of Dioscuri
  - 32 Street of Mercury.
  - 33 street altar
  - 34 Gate of Nola
  - 35 inside of walls
  - 36 scene of great theatre
- altan Aesculapius



CHALCIDICUM - Bechi's measures

Covered with marble. 122 feet long 36 wide

The Chalcidicum has 16 pilastres. 3 ft square.

Covered with beams.

Bechi calls the portico toward the Forum Chalid.

Eumachia daughter of Lucius. public Priestess, in

Her name & that of Lucius Frontinus - Her Son

built with her money the Chalcidicum the Crypt

& the Porticos & dedicated them to Concordia

Augusta pieta -

Entering - the porticos had 28 marble Corinthian

columns. 148 feet long 27 wide. In the great

semicircle opposite on a pedestal the statue of

the Pieta Concordia - paved with marble.

The impluvium (Hypaethrum) 119 feet by 59.

marble steps & a gutter of stone, running to a cistern

Washing cisterns which were covered with marble.

Crypts 179 by 119 long & wide - 14 feet broad.

28 windows. painted red & yellow panels below flowers.

Status of Eumachia 5 feet 3 in. base 3 ft - called

Canaculum Terracotta Mint, Baths & caupidicum by

different authors - M. Bechi maintains that it was

only a portico. The inscriptions of the portico of

the Forum & the Chalcidicum of Pompeii alike.

Capt de Goro says Bechi's measures are wrong about 30 palms.

marini Fratelli arvali 313 p

ALFIA . P . F . QVART illa Balineum  
MVLIEBRE A SOLO sua . pec . extorqit  
EADEM LAPIDE Vario ...  
ORNAVIT LABRUM AENEUM  
FOCVLO SEDES POSVIT. . . .

Festus . attribuentas Jovi diurna fulmina , nocturna Sumano .

FVLGVR | Palazzo Rondanini .  
SUM . CONDIT | Summanum Conditum |  
Pluto = Summanus

